



Technical Standards and Safety Authority
www.tssa.org

14th Floor - Centre Tower
3300 Bloor Street West
Toronto Ontario M8X 2X4
Fax: 416 231 4078
Customer Service: 1.877.682.8772

Intake Group

Level 1 Risk and Safety Management Plan (RSMPL)

Technical Standards and Safety Act
Propane Storage and Handling Regulation

AUG 19 2016

- This Level 1 RSMPL applies to:
- a facility with a total propane storage capacity of 5,000 USWG or less; or
 - a facility with a fixed propane storage capacity of less than 5,000 USWG and no more than 500 USWG of portable propane storage capacity.

Failure to fully complete this form may result in rejection.
Making a false statement may result in a fine or prosecution
under the *Technical Standards and Safety Act*

Licence Number

Check applicable type of propane operations.

Cylinder Motor Fill Filling Plant Card/Keylock

Submit along with this completed application a Facility Site Plan and a Map of the Surrounding Area.

SECTION A: GENERAL INFORMATION

The Undersigned applies to TSSA for a review for an RSMPL under Ontario's *Technical Standards and Safety Act*, Propane Storage and Handling Regulation.

Company Name		Corporation No.	
A SERVICE DE PNEUS LAVOIE OUTAOUAIS INC.		1664621	
Operator Name (if different from above)			
Telephone No.	Fax No.	E-mail	
819.777.5999		tremblayc@pneulavoie.com	
B Street No.	Street Name / 911 Number / Address, if applicable		
27	Rue Mangin		
Town / City or Township / County		Province	Postal Code
Gatineau		Quebec	J8Y 3L8
Mailing address if different from above.			
C Street No.	Street Name / 911 Number / Address, if applicable		
Town / City or Township / County		Province	Postal Code

Information on Container Refill Centre or Filling Plant			
Location of facility.			
D Street No.	Street Name / 911 Number / Address, if applicable		Nearest Major Intersection
101	Innes Park Way		Bantree Street & Innes Road
Town / City or Township / County		Province	Postal Code
Ottawa		Ontario	K1B 1E3

Name of Licence Holder	
Pneus Lavoie Inc.	
Name of a Senior Management person as defined in the regulation holding the Record of Training (ROT).	ROT type
Carol Tremblay	PTI 100-02
Municipality (or municipalities if the facility or its hazard distance touches multiple borders)	
City of Ottawa	
Hours of operation.	

This document is valid until the next licence renewal date. You are required by law to notify TSSA of any change of information.

Declaration: I am aware that it is an offence to give false information in this document and I hereby declare that the information I have given here is true and complete.

Print name	Signature	Date (dd-mmm-yyyy)
Name of Licence Holder Pneus Lavoie Inc.		
Name of Senior Management person as defined in the Regulation holding the Record of Training Carol Tremblay		

DMC



Technical Standards and Safety Authority
www.tssa.org

14th Floor - Centre Tower
3300 Bloor Street West
Toronto Ontario M8X 2X4
Fax: 416.231.4078
Customer Service: 1.877.682.8772

Level 1 Risk and Safety Management Plan (RSMP)
Technical Standards and Safety Act
Propane Storage and Handling Regulation

SECTION A: GENERAL INFORMATION (cont'd)

Indicate the year the facility was established. 2016 Indicate the year of any significant modifications, as defined in s.1, O.Reg 211/01, since establishment.

Identify the psig rating and serial number for each fixed propane storage tank on site.

	PSIG	Serial Number
Tank 1:	250 psig	20J83-8; CRN: B7629-65489P432
Tank 2:		
Tank 3:		

Enter capacity of propane in USWG, fixed, portable, and mobile, and provide detailed inventory that includes the number of tank/vessel for each type (fixed, portable, and mobile) and the capacity of each tank/vessel, on a separate document.

Fixed: 2000 USWG Portable: 0 Mobile: 0

Declaration: I am aware that it is an offence to give false information in this document and I hereby declare that the information I have given here is true and complete.

Name of person completing this form (please print) Guy Marchand	Official Title President (P38 Energy Inc.)
Signature 	Telephone No. 450.373.4333
	Date (dd-mmm-yyyy) <u>13-01-2016</u>

GMC



Technical Standards and Safety Authority
www.tssa.org

14th Floor - Centre Tower
3300 Bloor Street West
Toronto Ontario M8X 2X4
Fax: 416.231.4078
Customer Service: 1.877.682.8772

Level 1 Risk and Safety Management Plan (RSMP)
Technical Standards and Safety Act
Propane Storage and Handling Regulation

SECTION A: GENERAL INFORMATION (cont'd)

Activity Information

Name of Propane Supplier(s)		[Redacted]	
P38 Energy Inc.			
Street No.	Street Name / 911 Number / Address, if applicable		
683	Larocque Road		
Town / City or Township / Country		Province	Postal Code
Valleyfield		Quebec	J6T 4E1
Telephone No.	Fax No.	Contact Name	
450.373.4333	450.373.3336	Guy Marchand	
E-mail			
guy@budgetpropane.com			

Name of Propane Transporter. If same as above, please check box. <input checked="" type="checkbox"/>		For Office Use - Party No.	
Street No.	Street Name / 911 Number / Address, if applicable		
Town / City or Township / Country		Province	Postal Code
Telephone No.	Fax No.	Contact Name	
E-mail			

Off-site Cylinder and/or Mobile Storage		Capacity stored off-site, in USWG	For Office Use - Party No.
N/A			
Street No.	Street Name / 911 Number / Address, if applicable		
Town / City or Township / Country		Province	Postal Code
Telephone No.	Fax No.	Contact Name	

Note: Customer storage is not considered off-site storage.

Declaration: I am aware that it is an offence to give false information in this document and I hereby declare that the information I have given here is true and complete.

Name of person completing this form (please print)		Official Title	
Guy Marchand		President (P38 Energy Inc.)	
Signature		Telephone No.	Date (dd-mmm-yyyy)
		450.373.4333	12/01/2016

D.M.C.



Technical Standards and Safety Authority
www.tssa.org

14th Floor - Centre Tower
3300 Bloor Street West
Toronto Ontario M8X 2X4
Fax: 416.231.4078
Customer Service: 1.877.682.8772

Level 1 Risk and Safety Management Plan (RSMP)
Technical Standards and Safety Act
Propane Storage and Handling Regulation

SECTION B: EMERGENCY AND PREPAREDNESS RESPONSE PLAN

The licence holder will complete Section B in consultation with the local Fire Services.

Description of the maximum volume, types and storage location of other hazardous materials on site, if any.

No materials stored on site other than those required for Pneus Lavoie's daily commercial services (changing engine and transmission oil and other engine and auto fluids). All items are stored within the shop.

Description of fire and emergency equipment indicated on facility site map.

Emergency Shutdown Buttons - Stops pumping operations and seals all tank outlets on the bottom of the tank.

Fire extinguisher - 20lb A,B,C

Fire Hydrants - Two hydrants located north of the facility along Sheffield Rd.

List of fire protection controls (e.g., fire detection systems, fire notification systems, alarm systems, automatic shut off devices, fusible links, etc.) and describe their function, use and operation.

Internal Safety Control (ISC) valve is equipped with nitrogen charged actuator.

Fusible link on each end of actuator holding open ISC valve causes liquid outlet to automatically close in event of fire.

Polyethylene hose used to carry pneumatic pressure to ISC actuators will melt in case of a fire.

Normally closed solenoid valves on automotive fill meter.

Maintenance and testing schedule for fire protection controls and devices.

Dispenser fire extinguisher is inspected by outside company annually and inspected in-house monthly.

Comprehensive dispenser inspection conducted annually by G2-LP certificate holder or higher.

Facility inspection by TSSA completed annually.

Declaration: I am aware that it is an offence to give false information in this document and I hereby declare that the information I have given here is true and complete.

Name of person completing this form (please print) Guy Marchand		Official Title President (P38 Energy Inc.)	
Signature 		Telephone No. 450.373.4333	Date (dd-mmm-yyyy) 12/01/2016

D.M.C.



Technical Standards and Safety Authority
www.tssa.org

14th Floor - Centre Tower
3300 Bloor Street West
Toronto Ontario M8X 2X4
Fax: 416.231.4078
Customer Service: 1.877.682.8772

Level 1 Risk and Safety Management Plan (RSMP)
Technical Standards and Safety Act
Propane Storage and Handling Regulation

SECTION B: EMERGENCY AND PREPAREDNESS RESPONSE PLAN (cont'd)

1. Contacts for Emergency Response

1. Facility Contact Personnel - Key Contact		5. Facility 24-Hour Contact Person	
Name Carol Tremblay	For Office Use - Party No.	Name Bruno Bissonnette	For Office Use - Party No.
Official Title Director of Operations		Official Title Facility Manager	
Telephone No. 819.777.5999	Fax No.	Cell No. 819.360.3315	Fax No.
E-mail tremblayc@pneulavoie		E-mail bissonneteb@pneulavoie.com	
Role and responsibilities in emergency Represent licence holder/operator on interaction with authorities Ensure regulations are met		Role and responsibilities in emergency Site liaison for enacting internal and external emergency procedures Communication with emergency responders, supplier and subcontractors	
2. Facility Contact Personnel - Alternate Contact		6. Name of Facility Manager	
Name Bruno Bissonnette	For Office Use - Party No.	Name Bruno Bissonnette	For Office Use - Party No.
Official Title Facility Manager		Official Title Facility Manager	
Telephone No. 819.360.3315	Fax No.	Telephone No. 819.360.3315	Fax No.
E-mail bissonneteb@pneulavoie.com		E-mail bissonneteb@pneulavoie.com	
Role and responsibilities in emergency Same as Key Contact and/or Facility 24 Hr Contact if other unavailable		Role and responsibilities in emergency Ensure approved procedures are followed Ensure internal emergency procedures are current and employees aware	
3. Local Fire Services - Key Contact		7. Propane Supplier Key Contact Person	
Name Duncan McNaughton, P. Eng	For Office Use - Party No.	Name Guy Marchand	For Office Use - Party No.
Official Title Fire Protection Engineer	E-mail duncan.mcnaughton@ottawa.ca	Official Title President	E-mail guy@budgetpropane.com
Telephone No. 613.580.2424 ext. 29603	Fax No. 613.580.9613	Telephone No. 450.373.4333	Fax No. 450.373.3336
Role and responsibilities in emergency Review and provide guidance on fire safety, emergency response and preparedness		Role and responsibilities in emergency Technical assistance; dispatch of service technician and specialized equipment Activate Emergency Response Assistance Plan by ERAC	
Fire Services Address 101 Centrepointe, Ottawa, ON		Propane Supplier Address 683 Larocque Rd, Valleyfield, Quebec	
4. Local Fire Services - Alternate Contact		8. Municipal Contact	
Name Gerry Pingitore	For Office Use - Party No.	Name John Lunney	For Office Use - Party No.
Official Title Fire Chief	E-mail gerry.pingitore@ottawa.ca	Official Title Development Information Officer	
Telephone No. 613.580.2424 ext. 41362	Fax No. 613.580.9613	Telephone No. 613.580.2424 ext. 16588	Fax No.
Role and responsibilities in emergency Review and provide guidance on fire safety, emergency response and preparedness		E-mail john.lunney@ottawa.ca	
Fire Services Address 101 Centrepointe, Ottawa, ON		Municipality Name and Address City of Ottawa, 110 Laurier Avenue West, Ottawa, ON	

Declaration: I am aware that it is an offence to give false information in this document and I hereby declare that the information I have given here is true and complete.

Name of person completing this form (please print) Guy Marchand	Official Title President (P38 Energy Inc.)
Signature 	Telephone No. 450.373.4333
	Date (dd-mmm-yyyy) 13-01-2016

J. MC.



Technical Standards and Safety Authority
www.tssa.org

14th Floor - Centre Tower
3300 Bloor Street West
Toronto Ontario M8X2X4
Fax: 416.231.4078
Customer Service: 1.877.682.8772

Level 1 Risk and Safety Management Plan (RSMP)
Technical Standards and Safety Act
Propane Storage and Handling Regulation

SECTION B: EMERGENCY AND PREPAREDNESS RESPONSE PLAN (cont'd)

2. Additional Safety Measures

Describe any other measures in place at the facility that exceed the minimum Code and Standards requirements.

- The Internal Safety Control valve is pneumatically actuated with nitrogen, additional protection provided with fusible links.
- Limited Scope of Filling: Only non-retail vehicle filling is done; into vehicles with automatic stop fill valves.
- Card Lock System: In order to operate propane filling system an operator requires a card issued by Pneus Lavoie; prevents any unauthorized use.
- Bollards protect dispensing system from vehicular impact.

Declaration: I am aware that it is an offence to give false information in this document and I hereby declare that the information I have given here is true and complete.

Name of person completing this form (please print) Guy Marchand	Official Title President (P38 Energy Inc.)	
Signature 	Telephone No. 450.373.4333	Date (dd-mmm-yyyy) 13-01-2016

D. Mc.



Technical Standards and Safety Authority
www.tssa.org

14th Floor - Centre Tower
3300 Bloor Street West
Toronto Ontario M8X 2X4
Fax: 416.231.4078
Customer Service: 1.877.682.8772

Level 1 Risk and Safety Management Plan (RSMP)
Technical Standards and Safety Act
Propane Storage and Handling Regulation

SECTION B: EMERGENCY AND PREPAREDNESS RESPONSE PLAN (cont'd)

3. Record of Emergency Training Provided - For most recent 12-month period.

Training on Emergency Response Plan and Procedures provided to facility key contacts.

Training Date (dd-mmm-yyyy) TBD	Print Name of Training Provider: P38 Energy Inc.
	Print Name of Instructor: Terry Wright and Guy Marchand
Training Date (dd-mmm-yyyy)	Print Name of Training Provider:
	Print Name of Instructor:
Training Date (dd-mmm-yyyy)	Print Name of Training Provider:
	Print Name of Instructor:

Training on the facility's Emergency Management Procedures provided to staff.

Training Date (dd-mmm-yyyy) TBD	Print Name of Training Provider: P38 Energy Inc.
	Print Name of Instructor: Terry Wright and Guy Marchand
Training Date (dd-mmm-yyyy)	Print Name of Training Provider:
	Print Name of Instructor:
Training Date (dd-mmm-yyyy)	Print Name of Training Provider:
	Print Name of Instructor:

On-site specific training provided to certificate holders / persons with Records of Training.

Training Date (dd-mmm-yyyy) TBD	Print Name of Training Provider: P38 Energy Inc.
	Print Name of Instructor: Terry Wright and Guy Marchand
Training Date (dd-mmm-yyyy)	Print Name of Training Provider:
	Print Name of Instructor:
Training Date (dd-mmm-yyyy)	Print Name of Training Provider:
	Print Name of Instructor:

Declaration: I am aware that it is an offence to give false information in this document and I hereby declare that the information I have given here is true and complete.

Name of person completing this form (please print) Guy Marchand	Official Title President (P38 Energy Inc.)
Signature 	Telephone No. 450.373.4333
	Date (dd-mmm-yyyy) 13/01/2016

D. M.C.



Technical Standards and Safety Authority
www.tssa.org

14th Floor - Centre Tower
3300 Bloor Street West
Toronto Ontario M8X 2X4
Fax: 416.231.4078
Customer Service: 1.877.682.8772

Level 1 Risk and Safety Management Plan (RSMP)
Technical Standards and Safety Act
Propane Storage and Handling Regulation

SECTION B: EMERGENCY AND PREPAREDNESS RESPONSE PLAN (cont'd)

4. Emergency Training Plan for Coming Year

Training on Emergency Response Plan and Procedures provided to facility key contacts.

Target Date (dd-mmm-yyyy) TBD	Print Name of Training Provider: P38 Energy Inc.
	Print Name of Instructor: Terry Wright and Guy Marchand
Target Date (dd-mmm-yyyy)	Print Name of Training Provider:
	Print Name of Instructor:
Target Date (dd-mmm-yyyy)	Print Name of Training Provider:
	Print Name of Instructor:

Training on the facility's Emergency Management Procedures provided to staff.

Target Date (dd-mmm-yyyy) TBD	Print Name of Training Provider: P38 Energy Inc.
	Print Name of Instructor: Terry Wright and Guy Marchand
Target Date (dd-mmm-yyyy)	Print Name of Training Provider:
	Print Name of Instructor:
Target Date (dd-mmm-yyyy)	Print Name of Training Provider:
	Print Name of Instructor:

On-site specific training provided to certificate holders / persons with Records of Training.

Target Date (dd-mmm-yyyy) TBD	Print Name of Training Provider: P38 Energy Inc.
	Print Name of Instructor: Terry Wright and Guy Marchand
Target Date (dd-mmm-yyyy)	Print Name of Training Provider:
	Print Name of Instructor:
Target Date (dd-mmm-yyyy)	Print Name of Training Provider:
	Print Name of Instructor:

Declaration: I am aware that it is an offence to give false information in this document and I hereby declare that the information I have given here is true and complete.

Name of person completing this form (please print) Guy Marchand	Official Title President (P38 Energy Inc.)
Signature 	Telephone No. 450.373.4333
	Date (dd-mmm-yyyy) 13/01/2016

G. MC.



Technical Standards and Safety Authority
www.tssa.org

14th Floor - Centre Tower
3300 Bloor Street West
Toronto Ontario M8X 2X4
Fax: 416.231.4078
Customer Service: 1.877.682.8772

Level 1 Risk and Safety Management Plan (RSMP)
Technical Standards and Safety Act
Propane Storage and Handling Regulation

SECTION B: EMERGENCY AND PREPAREDNESS RESPONSE PLAN (cont'd)

The licence holder will complete Section B in consultation with the local Fire Services.

5. Emergency Response Communications Plan

Warnings and Actions

Describe who gives warnings to whom, and how and when the warning will be given (including public notification as appropriate).

In the event of a fire/significant propane leak the operator will activate the Emergency Stop control on the dispenser and/or delivery truck.

The operator will contact Fire Services by calling 9-1-1 and initiate facility evacuation.

Fire Services will oversee public notification and/or evacuation, including neighbors within the multi-use building at 101 Innes Park Way.

Facility Contact will contact Propane Supplier Key Contact who will activate ERAP (if necessary) and report to TSSA through Spills Action Centre.

Describe what action is to be taken and by whom when a warning is issued (including details of a meeting place in a safe identified area and activating the evacuation plan, if necessary).

The operator immediately after activating the Emergency Stop control, will verbally notify any other employees and visitors on site to evacuate, then call 9-1-1.

All employees and visitors (customers) will immediately vacate the building and premises to Sheffield Road and await direction from emergency responders.

Communication with Emergency Response Authorities

Describe when and how the licence holder will give early warning to emergency response authorities (including a process to ensure that a call is placed to 911).

All employees are instructed to and authorized to activate emergency response authorities by calling 9-1-1 upon occurrence of fire and/or significant leak.

Describe provisions for fire department entry when there are no operations or staffing at the propane site.

Propane facility is accessible at all times; not fenced.

Describe how the licence holder will ensure continual flow of updated information to authorities.

Fire Services are formally invited for a full site review on an annual basis with supplementary site access for training or orientation as requested.

TSSA conducts a comprehensive inspection annually. Site specific emergency procedures are reviewed annually with all employees.

How long will it take the facility liaison person to respond to the site.

Key Contact would be able to respond to site in approximately 20 min.

Declaration: I am aware that it is an offence to give false information in this document and I hereby declare that the information I have given here is true and complete.

Name of person completing this form (please print) Guy Marchand	Official Title President (P38 Energy Inc.)
Signature 	Telephone No. 450.373.4333
	Date (dd-mm-yyyy) 13/01/2016

D.M.C.



Technical Standards and Safety Authority
www.tssa.org

14th Floor - Centre Tower
3300 Bloor Street West
Toronto Ontario M8X 2X4
Fax: 416.231.4078
Customer Service: 1.877.682.8772

Level 1 Risk and Safety Management Plan (RSMP)
Technical Standards and Safety Act
Propane Storage and Handling Regulation

SECTION B: EMERGENCY AND PREPAREDNESS RESPONSE PLAN (cont'd)

The licence holder will complete Section B in consultation with the local Fire Services.

6. Building and Site Security and Procedures

	Yes	No
1. Does the propane location have controlled access to limit unnecessary risk and entry (lock out procedures)?	<input type="checkbox"/>	<input checked="" type="checkbox"/>
2. Is there adequate night lighting at the site?	<input checked="" type="checkbox"/>	<input type="checkbox"/>
3. Are procedures in place that ensure access routes, aisles, storage area, filling areas and the grounds are kept clear from unwanted materials?	<input checked="" type="checkbox"/>	<input type="checkbox"/>
4. Are there procedures that capture and record the daily inspection of hoses and inspection requirements for filling systems and mechanical devices used in the transfer of propane?	<input checked="" type="checkbox"/>	<input type="checkbox"/>
5. Does the facility have procedures that include a process to isolate and purge any overfilled propane cylinders?	<input type="checkbox"/>	<input checked="" type="checkbox"/>
6. Are weighing systems validated for accuracy?	<input type="checkbox"/>	<input checked="" type="checkbox"/>
7. Are storage areas clearly marked with the vessels' capacity status (i.e., filled, empty, purged and other hazardous materials)?	<input type="checkbox"/>	<input checked="" type="checkbox"/>
8. Are quality assurance procedures in place to ensure that all valves are closed after the propane cylinders are filled?(e.g., QCC valves)	<input checked="" type="checkbox"/>	<input type="checkbox"/>
9. Is the schedule of maintenance and testing activities retained on site?	<input checked="" type="checkbox"/>	<input type="checkbox"/>

7. Water Supply

The propane licence holder should work with the local fire department to determine water supply capabilities that are available based on the propane facility's location.

	Yes	No
1. Is a pressurized water system available at the propane facility site?	<input checked="" type="checkbox"/>	<input type="checkbox"/>
2. Can the municipal fire department pump 375 GPM (1420 LPM) of water at this location?	<input checked="" type="checkbox"/>	<input type="checkbox"/>
3. What is the unobstructed distance to the closest water supply that could be used for firefighting activities? (distance in metres only)		<u>56m</u>
4. What is the unobstructed distance to the closest approved water supply with year round access if there are no hydrants? (distance in metres only)		<u>N/A</u>

Declaration: I am aware that it is an offence to give false information in this document and I hereby declare that the information I have given here is true and complete.

Name of person completing this form (please print) Guy Marchand	Official Title President (P38 Energy Inc.)	
Signature 	Telephone No. 450.373.4333	Date (dd-mm-yyyy) 13/01/2016

D. MC



Technical Standards and Safety Authority
www.tssa.org

14th Floor - Centre Tower
3300 Bloor Street West
Toronto Ontario M8X 2X4
Fax: 416.231.4078
Customer Service: 1.877.682.8772

Level 1 Risk and Safety Management Plan (RSMP)
Technical Standards and Safety Act
Propane Storage and Handling Regulation

SECTION B: EMERGENCY AND PREPAREDNESS RESPONSE PLAN (cont'd)

The licence holder will complete Section B in consultation with the local Fire Services.

8. Licence holder and local Fire Services Review

To be completed by the Local Fire Services

Has the local fire service had an opportunity to review the Emergency Response and Preparedness Plan?

Yes No

If not, please explain (e.g., no fire services).

Fire services comments, if any:

No OFS comments

To be completed by the Licence Holder

In response to the above comments, the following action(s) is required:

The licence holder will respond to the Local Fire Services comments by: _____

(dd-mmm-yyyy)

LOCAL FIRE SERVICES

The undersigned has reviewed Section B of the Risk and Safety Management Plan Fire Services.

<i>DUNCAN</i> Local Fire Services Name	Print name <i>MENAUHAW</i>	Signature <i>[Signature]</i>	Date (dd-mmm-yyyy) <i>Jan 22 / 2016</i>
---	-------------------------------	---------------------------------	--

Declaration: I am aware that it is an offence to give false information in this document and I hereby declare that the information I have given here is true and complete.

Name of person completing this form (please print) Guy Marchand	Official Title President (P38 Energy Inc.)	
Signature <i>[Signature]</i>	Telephone No. 450.373.4333	Date (dd-mmm-yyyy) <i>13/01/2016</i>

D.M.C.



Technical Standards and Safety Authority
www.tssa.org

14th Floor - Centre Tower
3300 Bloor Street West
Toronto Ontario M8X 2X4
Fax: 416.231.4078
Customer Service: 1.877.682.8772

Level 1 Risk and Safety Management Plan (RSMP)
Technical Standards and Safety Act
Propane Storage and Handling Regulation

SECTION C: SUBMISSIONS

Applicant must include a Facility Site Plan and Map of Surrounding Area

Facility Site Plan.

The licence holder will submit a copy of the original facility site plan updated with the following information:

1. The storage location of fixed, portable, and mobile vessels.
2. The maximum volume, types and storage location of hazardous materials.
3. Location of permanent structures on site.
4. Access and egress points and location of barriers.
5. Location of fire and emergency equipment (e.g., sprinkler systems, extinguishers, suppression systems) on site and location of fire hydrant or water supply where available.
6. Location of emergency shut off/shut down switches/valves.

Map of Surrounding Area.

The licence holder will submit a scaled aerial map of the surrounding area showing the following information:

7. The capacity and placement of the single largest propane storage vessel, including its setback from the front, rear and side property lines.
8. GPS co-ordinates of the single largest vessel.
9. Visual indication of the single largest fixed vessel and a circle made using the distance in Table 1 as the radius from the single largest fixed vessel.
10. Clear indication of the municipality or municipalities present within the circle.
11. Visual indication of property line information.
12. The location and name of roads within or abutting the site.
13. Key note to the drawing indicating the facility's municipal address, municipal lot number(s) and concession lines as applicable, and the date the map was prepared.
14. Address and contact information for each municipality (municipal clerk or secretary-treasurers of planning board). (Refer to page 5.)
15. Complete "Required Mapping Information from Updated Site Plan" in table below .

Required Mapping Information from Updated Site Plan

Date map prepared (dd-mmm-yyyy) 27-dec-2015	Capacity of single largest propane storage vessel (USWG) 2000
Tank setback coordinates. Indicate placement on the map.	
Front: 29.5m (97ft)	Right side property line: 32.4m (106ft)
Rear: 321.8m (1056ft)	Left side property line: 83.6m (274ft)
GPS coordinates of single largest vessel: 45°24'37.68"N; 75°36'48.24"W	

Declaration: I am aware that it is an offence to give false information in this document and I hereby declare that the information I have given here is true and complete.

Name of person completing this form (please print) Guy Marchand	Official Title President (P38 Energy Inc.)
Signature 	Telephone No. 450.373.4333
	Date (dd-mmm-yyyy) 12/01/2016

D.M.C.



Technical Standards and Safety Authority
www.tssa.org

14th Floor - Centre Tower
3300 Bloor Street West
Toronto Ontario M8X 2X4
Fax: 416.231.4078
Customer Service: 1.877.682.8772

Level 1 Risk and Safety Management Plan (RSMP)
Technical Standards and Safety Act
Propane Storage and Handling Regulation

SECTION C: SUBMISSIONS (cont'd)

Applicant must include a Facility Site Plan and Map of Surrounding Area

Table 1: Distance Table

Water Capacity (litres)	Nominal Water Capacity (USWG)	Distance to 1 psi overpressure (m)
1,890	500	155
3,780	1,000	195
4,920	1,300	213
6,620	1,750	235
7,130	1,885	241
7,560	2,000	246
18,900	5,000	333

Formula: $D = 16.94 \times (1.524 \times C)^{1/3}$
 D = Distance to overpressure of 1 psi (meters)
 C = Tank Total Capacity in USWG

Parameters: Density of Propane is 0.5033 kg per litre @ 15 C
 Assume all vessels are 80% full
 1 gallon [US, liquid] = 0.003785411784 cubic meter
 1 cubic metre = 264.17 USWG

Hazard Distance Chart (EPA-TNT model)

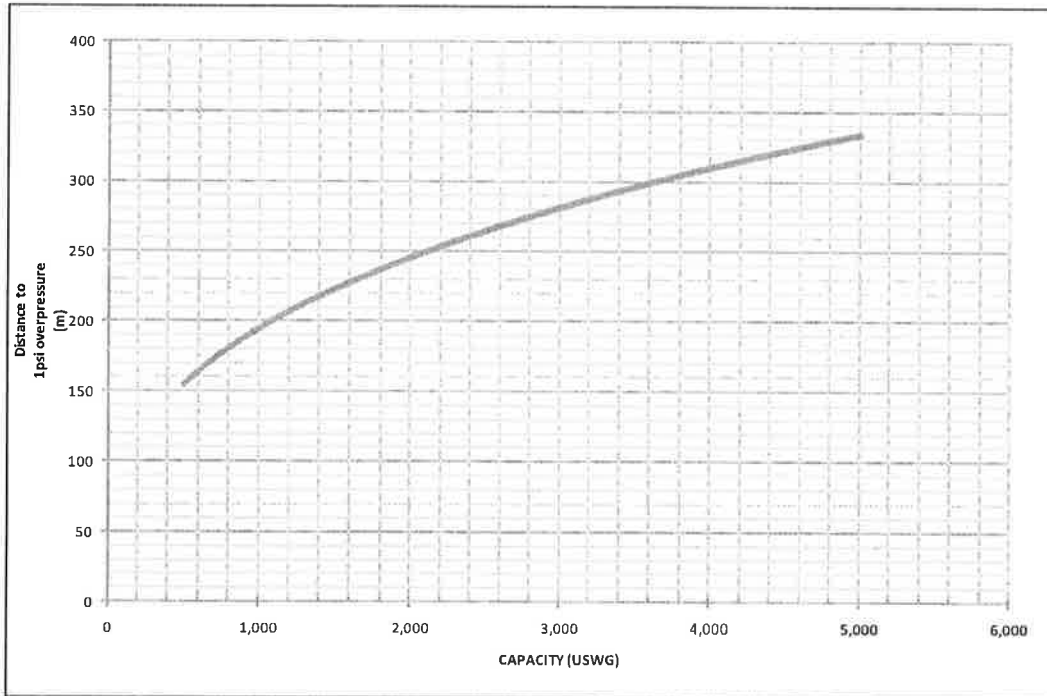

D.M.P.



Technical Standards and Safety Authority
www.tssa.org

14th Floor - Centre Tower
3300 Bloor Street West
Toronto Ontario M8X 2X4
Fax: 416.231.4078
Customer Service: 1.877.682.8772

Level 1 Risk and Safety Management Plan (RSMP)
Technical Standards and Safety Act
Propane Storage and Handling Regulation

SECTION C: SUBMISSIONS (cont'd)

Applicant must include a Facility Site Plan and Map of Surrounding Area

As an accompaniment to the Map of Surrounding Area, provide the following information about buildings and features present within the circle in Table 2.

Table 2: Buildings and Features

Buildings and Features Present within the Circle on the Map of the Surrounding Area AND Name and Address of Closest Building or Feature	* Number of Buildings and Features (mark with an "X")				Distance from Tank to Closest Building or Feature
	0	1	2-10	11+	
Industrial buildings or parks or golf courses Name: Petro Pass Address: 1400 Windmill Lane City: Ottawa Province Ontario Postal Code K1B 4V5		X			171 m
Residential building units specifically permanent single family dwellings, condominiums, and apartments. Name: _____ Address: _____ City: _____ Province _____ Postal Code _____	X				_____ m
Commercial building units specifically retail, restaurants, entertainment, theatres, and sporting complexes. Name: Multi-tenant commercial Address: 1280 Old Innes Road City: Ottawa Province Ontario Postal Code K1B 5M7			X		124 m
Commercial building units – continuous occupancy specifically hotels, campgrounds, and resorts. Name: _____ Address: _____ City: _____ Province _____ Postal Code _____	X				_____ m
Sensitive institutions specifically hospitals, schools and day cares, nursing and retirement homes, mental health institutions, and prisons. Name: _____ Address: _____ City: _____ Province _____ Postal Code _____	X				_____ m
Emergency responders specifically fire stations, ambulance stations, and police stations. Name: _____ Address: _____ City: _____ Province _____ Postal Code _____	X				_____ m

* For multi-unit buildings, count each unit as "1".

Declaration: I am aware that it is an offence to give false information in this document and I hereby declare that the information I have given here is true and complete.

Name of person completing this form (please print) Guy Marchand	Official Title President (P38 Energy Inc.)
Signature 	Telephone No. 450.373.4333
	Date (dd-mmm-yyyy) 13-01-2016

D. M.C.



Technical Standards and Safety Authority
www.tssa.org

14th Floor - Centre Tower
3300 Bloor Street West
Toronto Ontario M8X 2X4
Fax: 416.231.4078
Customer Service: 1.877.682.8772

Level 1 Risk and Safety Management Plan (RSMP)
Technical Standards and Safety Act
Propane Storage and Handling Regulation

WORKSHEET

Portable Storage Additional Information Worksheet

Cylinder Size	Capacity in USWG	Quantity	Total Volume In USWG
# 420	123.9	0	
# 100	29.5	0	
# 40	11.75	0	
# 33.3	9.62	0	
# 30	8.8	0	
# 20	5.8	0	
# 10	2.9	0	
# 5	1.5	0	
Total Cylinder Capacity			0 USWG

Tanks Stored On-site Not Connected for Use

Tank Size In USWG	Quantity	Total Volume In USWG
Total Tank Capacity		0 USWG

Total Cylinder Capacity	0 USWG
Total Tank Capacity	0 USWG
Total Portable Capacity (Total Cylinder Capacity + Total Tank Capacity)	0 USWG

DMS



TSSA HAZARD DISTANCE:
246m (ALL WITHIN CITY OF
OTTAWA)

2000 USWG PROPANE
STORAGE TANK

PNEUS LAVOIE



[Handwritten signature]

LEGEND

- LOW DENSITY RESIDENTIAL
- HIGH DENSITY RESIDENTIAL
- INDUSTRIAL
- COMMERCIAL
- SENSITIVE PUBLIC
- AGRICULTURAL/VACANT LAND
- PROPERTY LINE

[Handwritten initials]

CITY OF OTTAWA
 RICK O'CONNOR, CITY CLERK AND SOLICITOR
 TEL: (613) 580-2400
 110 LAURIER AVENUE WEST
 OTTAWA, ONTARIO, K1P 1J1

FACILITY INFORMATION INFORMATION
ADDRESS: 101 INNES PARK WAY, OTTAWA, ON
TANK GPS COORDINATES: 45°24'37.68"N, 75°36'48.24"W
LEGAL DESCRIPTION: GLOUCESTER CON 3 OF PT LOT;25 RP
 5R12382 PARTS 21 AND; 22

SETBACKS
 FRONT (N): 29.5m (97')
 REAR (S): 321.8m (1056')
 RIGHT (E): 32.4m (106')
 LEFT (W): 83.6m (274')

- PUBLIC RECEPTORS**
- 1 MULTI-TENANT COMMERCIAL
 - 2 MULTI-TENANT COMMERCIAL
 - 3 NOBLE
 - 4 NATURAL RESOURCES CANADA - NATIONAL AIR
PHOTO LIBRARY FILM ARCHIVES
 - 5 VACANT LOT
 - 6 OTTAWA BRICK AND STONE
 - 7 PETRO PASS (FUELING STATION)
 - 8 SUZUKI DEALERSHIP

REV	DATE	REVISION	BY	APP'D

SLEGGERS ENGINEERED PRODUCTS INC.
 LONDON, ONTARIO

CUSTOMER: P38 ENERGY INC.

REFERENCE: 101 INNES PARK WAY, OTTAWA GIS MAPPING

TITLE: PNEUS LAVOIE - MAP OF SURROUNDING AREA

SCALE - NTS	WORK ORDER No. JRS15016	DRAWING No. LAVOIE MOSA R0
DATE - 2015/11/27		
DRN - JP	CHKD - AB	APP'D - P38

D.M.C.

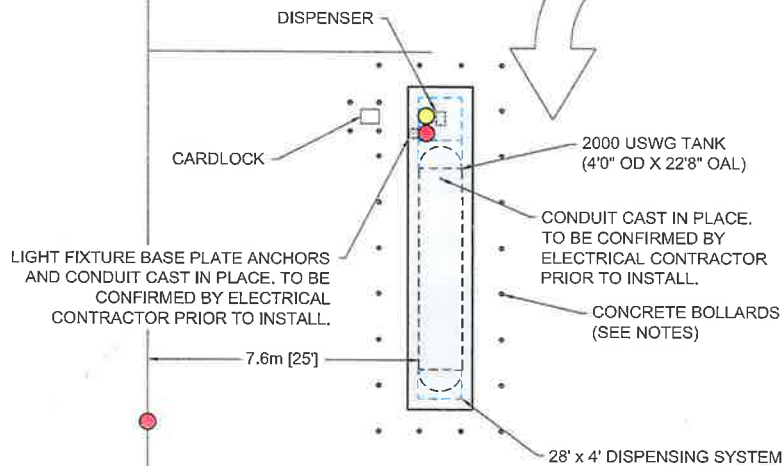

2000 USWG HORIZONTAL DISPENSER DETAILS

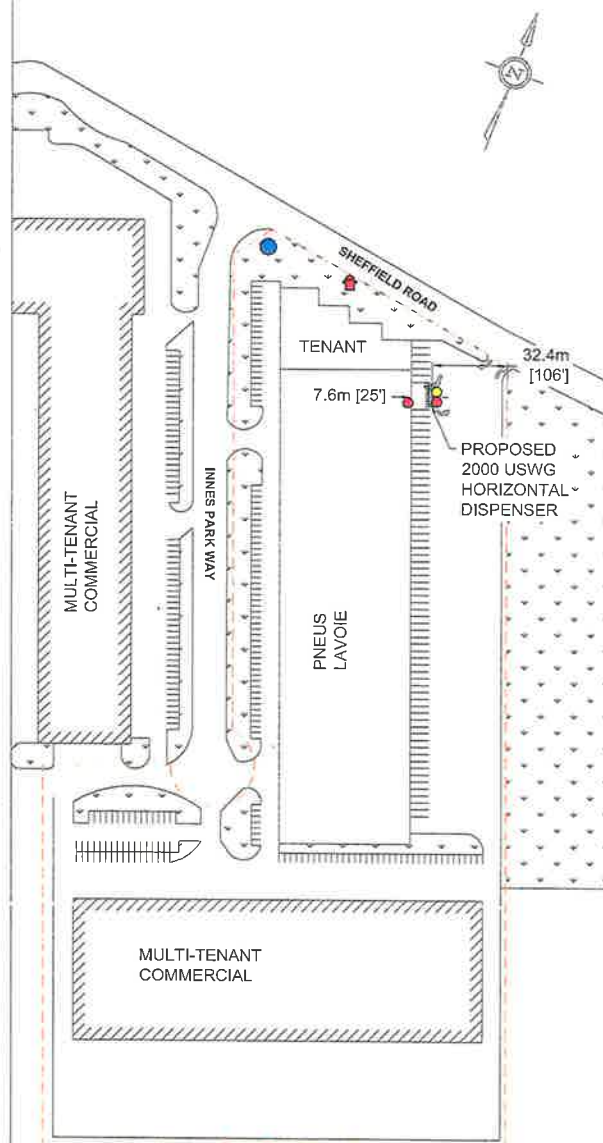

- LOCATION**
101 INNES PARK WAY
OTTAWA, ONTARIO
K1B 1E3
- AREA**
LOT AREA: 56,700 m² APPROX
BUILDING AREA: 11,600 m² APPROX
- ZONING INFORMATION**
ZONE IG3 - GENERAL INDUSTRIAL
- PROPANE STORAGE**
1-2000 USWG HORIZONTAL TANK AT 88.6%
- BOLLARDS**
- SPACED AT MOST 4.5' (1.35 m) APART
 - BURIED AT LEAST 3' (0.9 m) BELOW GRADE AND EXTEND 3' (0.9 m) ABOVE GRADE
 - SPACED AT LEAST 3.5' (1 m) FROM TANK
- CLEARANCES**
- 10' MIN. FROM THE PROPERTY LINES, CONCRETE/MASONRY BUILDING WALLS, OR SOURCES OF IGNITION
 - 25' MIN. FROM BUILDING OPENINGS AND WINDOWS
 - 25' MIN. FROM ANY DRAIN, SEWER, OR PIT
 - 25' MIN. FROM RAIL LINE
- SETBACKS TO PROPERTY LINE**
- NORTH - 29.5 m [97']
 - SOUTH - 321.8 m [1056']
 - EAST - 32.4 m [106']
 - WEST - 83.6 m [274']
- LEGEND**
- FIRE EXTINGUISHER
 - EMERGENCY SHUT OFF
 - EVACUATION POINT
 - - - PROPERTY LINE
 - ⇨ VEHICLE PATH
 - 🔥 FIRE HYDRANT

3	2015/12/17	ADDED FIRE HYDRANT APPROXIMATE LOCATION	JP	AB
2	2015/11/27	MODIFIED TANK LOCATION AND ORIENTATION, TITLE	JP	AB
1	2015/11/04	ADDED CARDLOCK, CHANGED LOCATION OF DISPENSER	KA	AB
REV	DATE	DESCRIPTION	BY	APPD

SLEEGERS ENGINEERED PRODUCTS INC.
LONDON, ONTARIO

CUSTOMER: P33 ENERGY INC.

REFERENCE: 101 INNES PARK WAY, OTTAWA, ONTARIO GIS MAPPING

TITLE: PNEUS LAVOIE - 2000 USWG HORIZONTAL DISPENSER

SCALE: AS SHOWN	WORK ORDER No.	DRAWING No.
DATE: 2015/11/03	JRS/15016	LAVOIE SP R3
DESIGNER: JRS	APPD: AB	

[Handwritten signature]