



**Technical Standards and Safety Authority**  
 www.tssa.org  
 14th Floor - Centre Tower  
 3300 Bloor Street West  
 Toronto Ontario M8X 2X4  
 Fax: 416.231.4903  
 Customer Service: 1.877.682.8772

**Level 1 Risk and Safety Management Plan (RSMP)**  
*Technical Standards and Safety Act*  
 Propane Storage and Handling Regulation

This Level 1 RSMP applies to:
 

- a facility with a total propane storage capacity of 5,000 USWG or less; or
- a facility with a fixed propane storage capacity of exactly 5,000 USWG and no more than 500 USWG of portable propane storage capacity on site.

Failure to fully complete this form may result in rejection.  
 Making a false statement may result in a fine or prosecution  
 under the *Technical Standards and Safety Act*

Licence Number 000226676.

Check applicable type of propane operations.

Cylinder     Motor Fill     Filling Plant     Card/Keylock

Submit along with this completed application a Facility Site Plan and a Map of the Surrounding Area.



**SECTION A: GENERAL INFORMATION**

The Undersigned applies to TSSA for a review for an RSMP under Ontario's *Technical Standards and Safety Act*, Propane Storage and Handling Regulation.

Company Name Blue Mountain Oil (Canada) Inc. Ontario Corporation No., if applicable

**A** Operator Name (if different from above) same

Telephone No. 613-965-6666 Fax No. 613-965-6928 E-mail paulhuangbm@gmail.com

**B** Street No. 110 Street Name / 911 Number / Address, if applicable HWY 33

Town / City or Township / County Trenton Province On Postal Code K8V 5P6

Mailing address if different from above.

**C** Street No. 110 Street Name / 911 Number / Address, if applicable HWY 33

Town / City or Township / County Trenton Province On Postal Code K8V 5P6

**Information on Container Refill Centre or Filling Plant**

Location of facility.

**D** Street No. 110 Street Name / 911 Number / Address, if applicable HWY 33 Nearest Major Intersection HWY 33 & Telephone Road HWY 33 & 401

Town / City or Township / County Trenton Province On Postal Code K8V 5P6

Name of Licence Holder Blue Mountain Oil (Canada) Inc.

Name of a Senior Management person as defined in the regulation holding the Record of Training (ROT) Yimei Zeng ROT type PTI 100-8 (PP0-3)

Municipality (or municipalities if the facility or its hazard distance touches multiple borders) City of Quinte West

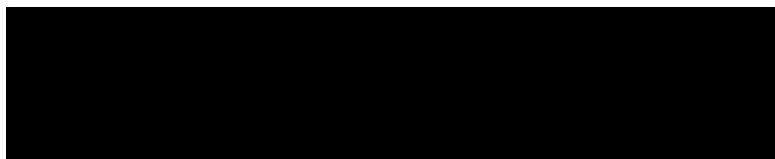
Hours of operation. 

This document is valid until the next licence renewal date. You are required by law to notify TSSA of any change of information.

Declaration: I am aware that it is an offence to give false information in this document and I hereby declare that the information I have given here is true and complete.

Print name Name of Licence Holder <u>Blue Mountain Oil (Canada) Inc.</u>	Signature 	Date (dd-mm-yyyy) <u>26-03-2014</u>
Name of Senior Management person as defined in the Regulation holding the Record of Training <u>Yimei Zeng</u>		



Technical Standards and Safety Authority  
www.tssa.org

14th Floor - Centre Tower  
3300 Bloor Street West  
Toronto Ontario M8X 2X4  
Fax: 416.231.4903  
Customer Service: 1.877.682.8772

**Level 1 Risk and Safety Management Plan (RSMP)**  
**Technical Standards and Safety Act**  
Propane Storage and Handling Regulation

**SECTION A: GENERAL INFORMATION (cont'd)**

Indicate the year the facility was established.      Indicate the year of any significant modifications, as defined in s.1, O.Reg 211/01, since establishment.

Unknown      Jan 29, 2010

Identify the psig rating and serial number for each fixed propane storage tank on site.

	PSIG	Serial Number
Tank 1:	250	9J81-4
Tank 2:	_____	_____
Tank 3:	_____	_____

Enter capacity of propane in USWG, fixed, portable, and mobile, and provide detailed inventory that includes the number of tank/vessel for each type (fixed, portable, and mobile) and the capacity of each tank/vessel, on a separate document.

Fixed: 2000 USWG      Portable: 131      Mobile: 0

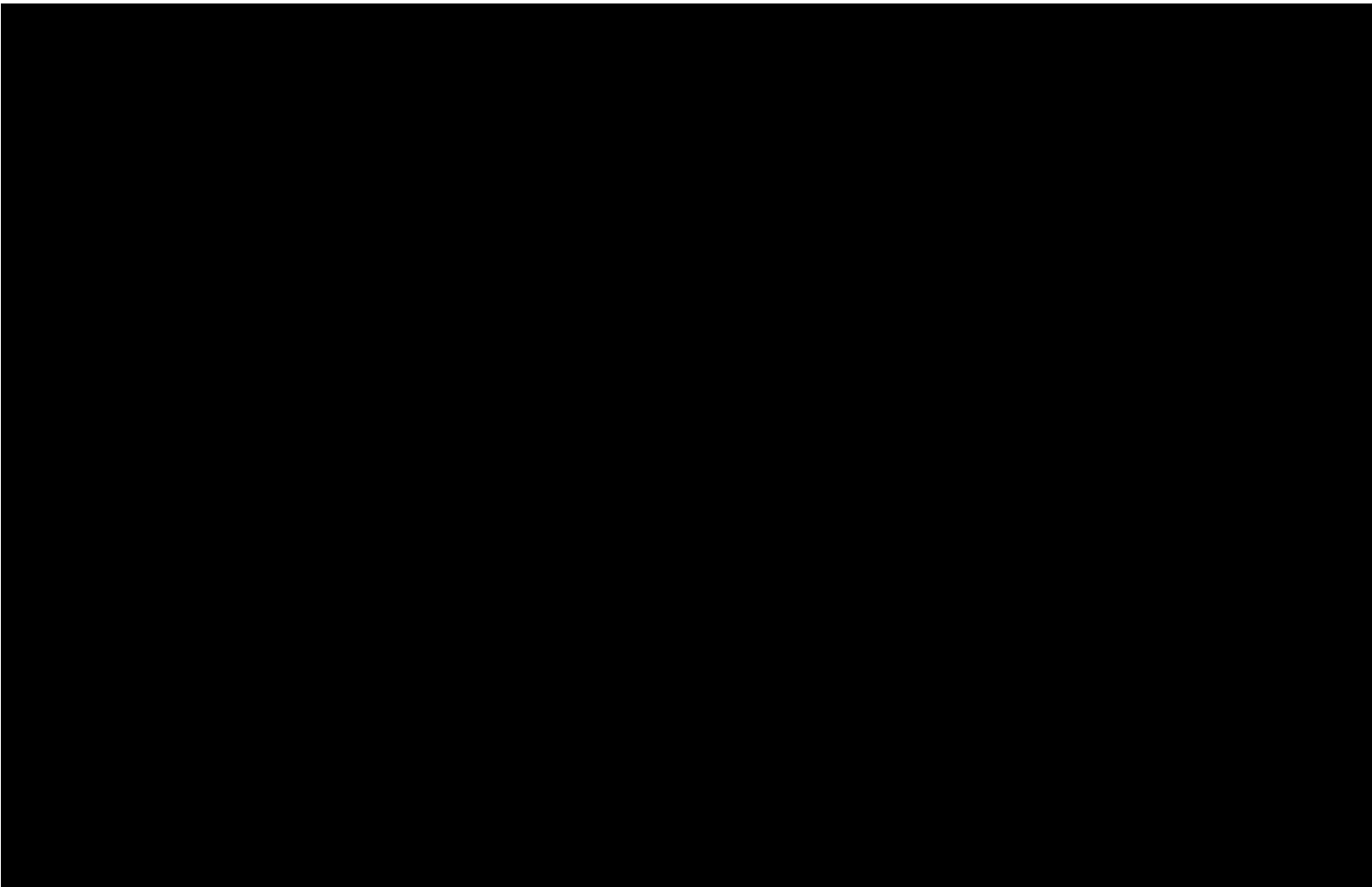

**Declaration: I am aware that it is an offence to give false information in this document and I hereby declare that the information I have given here is true and complete.**

Name of person completing this form (please print) Yimei Zeng		Official Title Officer	
Signature <i>Yimei Zeng</i>		Telephone No. 416-356-6616	Date (dd-mm-yyyy) 26-03-2014



**Technical Standards and Safety Authority**  
www.tssa.org

14th Floor - Centre Tower  
3300 Bloor Street West  
Toronto Ontario M8X 2X4  
Fax: 416.231.4903  
Customer Service: 1.877.682.8772

**Level 1 Risk and Safety Management Plan (RSMP)**

**Technical Standards and Safety Act**  
Propane Storage and Handling Regulation

**SECTION A: GENERAL INFORMATION (cont'd)**

Activity Information

<b>Name of Propane Supplier(s)</b> Superior Propane - Regional Operation Centre		For Office Use - Party No. [REDACTED]	
Street No. 251	Street Name / 911 Number / Address, if applicable Woodland Road East Unit 217		
Town / City or Township / Country Guelph		Province On	Postal Code N1H 8J1
Telephone No. 877-873-7467	Fax No. 519-836-7766	Contact Name Bruce Graham	
E-mail grahamb@superiorpropane.com			

<b>Name of Propane Transporter.</b> If same as above, please check box. <input type="checkbox"/>		For Office Use - Party No. [REDACTED]	
Superior Propane			
Street No. 686A	Street Name / 911 Number / Address, if applicable Dundas Street west		
Town / City or Township / Country Belleville		Province On	Postal Code K8N 4Z2
Telephone No. 613-962-9151	Fax No. 519-836-7766	Contact Name Shaun Mounstevan	
E-mail shaun_mounstevan@superiorpropane.com			

<b>Off-site Cylinder and/or Mobile Storage</b> None	Capacity stored off-site, in USWG	For Office Use - Party No.
Street No. / Street Name / 911 Number / Address, if applicable		
Town / City or Township / Country		Province / Postal Code
Telephone No.	Fax No.	Contact Name

Note: Customer storage is not considered off-site storage.

**Declaration: I am aware that it is an offence to give false information in this document and I hereby declare that the information I have given here is true and complete.**

Name of person completing this form (please print) Yimei Zeng	Official Title Officer	
Signature 	Telephone No. 416-356-6616	Date (dd-mm-yyyy) 26-03-2014



**Technical Standards and Safety Authority**  
www.tssa.org

14th Floor - Centre Tower  
3300 Bloor Street West  
Toronto Ontario M8X 2X4  
Fax: 416.231.4903  
Customer Service: 1.877.682.8772

**Level 1 Risk and Safety Management Plan (RSMP)**  
*Technical Standards and Safety Act*  
Propane Storage and Handling Regulation

**SECTION B: EMERGENCY AND PREPAREDNESS RESPONSE PLAN**

The licence holder will complete Section B in consultation with the local Fire Services.

Description of the maximum volume, types and storage location of other hazardous materials on site, if any.

Supreme Gasoline - 15,000 litre storage - underground tanks (as per attached site plan)

Regular Gasoline - 85,000 litre storage - underground tanks (as per attached site plan)

Diesel - 30,000 litre storage, - underground tank (as per attached site plan)

Description of fire and emergency equipment indicated on facility site map.

MOD 20 PCK1

Located @ 1 @ the Propane Dispenser

Located @ 1 each gasoline pump

Located @ 1 in store

List of fire protection controls (e.g., fire detection systems, fire notification systems, alarm systems, automatic shut off devices, fusible links, etc.) and describe their function, use and operation.

1- Fusible link on ISC - isolation valve between the tank and the downstream propane dispensing equipment.

2. Emergency Shut Off - at propane tank. This shuts down the pump and closes a solenoid valve upstream of hoses.

3. Power supply breaker inside the gas bar building. This cuts all power to the propane system - shuts down pump; closes solenoid valve.

Maintenance and testing schedule for fire protection controls and devices.

Maintenance and testing is undertaken by Superior Propane according to Superior 's Maintenance Standards. Schedule for key equipment is:

1- Pumps - (pumps every 3 months; pump motor: check belts monthly; grease pump every 6 months).

2- ISC valve (test for closure every 6 months).

3- Storage tank Relief Valves - inspected every 2 years; replacement schedule as per provincial regulations.

**Declaration: I am aware that it is an offence to give false information in this document and I hereby declare that the information I have given here is true and complete.**

Name of person completing this form (please print) Yimei Zeng		Official Title Officer
Signature 	Telephone No. 416-356-6616	Date (dd-mm-yyyy) 26-03-2014



**Technical Standards and Safety Authority**  
www.tssa.org

14th Floor - Centre Tower  
3300 Bloor Street West  
Toronto Ontario M8X 2X4  
Fax: 416.231.4903  
Customer Service: 1.877.682.8772

**Level 1 Risk and Safety Management Plan (RSMP)**  
**Technical Standards and Safety Act**  
Propane Storage and Handling Regulation

**SECTION B: EMERGENCY AND PREPAREDNESS RESPONSE PLAN (cont'd)**

1. Contacts for Emergency Response

<b>1. Facility Contact Personnel - Key Contact</b>		<b>5. Facility 24-Hour Contact Person</b>	
Name <u>Liang Huang</u>	For Office Use - Party No.	Name <u>Liang Huang</u>	For Office Use - Party No.
Official Title <u>Director</u>		Official Title <u>Director</u>	
Telephone No. <u>647-879-2919</u>	Fax No. <u>613-965-6928</u>	Cell No. <u>647-879-2919</u>	Fax No. <u>613-965-6928</u>
E-mail <u>paulhuangbm@gmail.com</u>		E-mail <u>paulhuangbm@gmail.com</u>	
Role and responsibilities in emergency <u>Co-ordinate site response plan (ERP)</u>		Role and responsibilities in emergency <u>Co-ordinate site response plan (ERP)</u>	
<b>2. Facility Contact Personnel - Alternate Contact</b>		<b>6. Name of Facility Manager</b>	
Name <u>Yimei Zeng</u>	For Office Use - Party No.	Name <u>Liang Huang</u>	For Office Use - Party No.
Official Title <u>Officer</u>		Official Title <u>Director</u>	
Telephone No. <u>416-356-6616</u>	Fax No. <u>613-965-5666</u>	Telephone No. <u>647-879-2919</u>	Fax No. <u>647-879-2919</u>
E-mail <u>paulhuangbm@gmail.com</u>		E-mail <u>paulhuangbm@gmail.com</u>	
Role and responsibilities in emergency <u>Co-ordinate site response plan (ERP)</u>		Role and responsibilities in emergency <u>Co-ordinate site response plan (ERP)</u>	
<b>3. Local Fire Services - Key Contact</b>		<b>7. Propane Supplier Key Contact Person</b>	
Name <u>John Whelan</u>	For Office Use - Party No.	Name <u>Superior Propane Hot Line</u>	For Office Use - Party No.
Official Title <u>Fire Chief</u>		Official Title	
Telephone No. <u>613-392-2841 ext 7464</u>	Fax No. <u>613-392-5608</u>	Telephone No. <u>877-873-7467</u>	Fax No. <u>N/A</u>
E-mail <u>johnh@quintwest.ca</u>		E-mail <u>n/a</u>	
Role and responsibilities in emergency <u>Coordinate Emergency Response / advise on Fire Service Response. Liaise with police services.</u>		Role and responsibilities in emergency <u>Identify and dispatch Superior Propane and or LPERGC emergency response personal as required</u>	
<b>4. Local Fire Services - Alternate Contact</b>		<b>8. Municipal Contact</b>	
Name <u>Greg King</u>	For Office Use - Party No.	Name <u>Donnalee Craig</u>	For Office Use - Party No.
Official Title <u>Senior Fire Prevention Officer</u>		Official Title <u>City Clerk</u>	
Telephone No. <u>613-392-2841 ext 7469</u>	Fax No. <u>613-392-5608</u>	Telephone No. <u>613-392-2841 ext 4445</u>	Fax No. <u>613-392-0131</u>
E-mail <u>gregk@quintwest.ca</u>		E-mail <u>donnalee@quintwest.ca</u>	
Role and responsibilities in emergency <u>Coordinate Emergency Response / advise on Fire Response when key contact is not available and liaise with police services.</u>		Municipality <u>City of Quinte West</u>	

**Declaration: I am aware that it is an offence to give false information in this document and I hereby declare that the information I have given here is true and complete.**

Name of person completing this form (please print) <u>Yimei Zeng</u>	Official Title <u>Officer</u>
Signature 	Telephone No. <u>416-356-6616</u>
	Date (dd-mm-yyyy) <u>26-03-2014</u>



**Technical Standards and Safety Authority**  
www.tssa.org

14th Floor - Centre Tower  
3300 Bloor Street West  
Toronto Ontario M8X 2X4  
Fax: 416.231.4903  
Customer Service: 1.877.682.8772

**Level 1 Risk and Safety Management Plan (RSMP)**  
**Technical Standards and Safety Act**  
Propane Storage and Handling Regulation

**SECTION B: EMERGENCY AND PREPAREDNESS RESPONSE PLAN (cont'd)**

2. Additional Safety Measures

Describe any other measures in place at the facility that exceed the minimum Code and Standards requirements.

E-stop located @ the dispenser area to cut the electrical in the event of an emergency, shutting the power of to the solenoid stopping the flow of propane.

Call Canadian National Railway (CRN) CN police 1-800-465-8239 incase of a major emergency, so trains cab be stopped

**Declaration: I am aware that it is an offence to give false information in this document and I hereby declare that the information I have given here is true and complete.**

Name of person completing this form (please print)		Official Title
Yimei Zeng		Officer
Signature	Telephone No.	Date (dd-mm-yyyy)
	416-356-6616	26-03-2014



**Technical Standards and Safety Authority**  
www.tssa.org

14th Floor - Centre Tower  
3300 Bloor Street West  
Toronto Ontario M8X 2X4  
Fax: 416.231.4903  
Customer Service: 1.877.682.8772

**Level 1 Risk and Safety Management Plan (RSMP)**  
**Technical Standards and Safety Act**  
Propane Storage and Handling Regulation

**SECTION B: EMERGENCY AND PREPAREDNESS RESPONSE PLAN (cont'd)**

3. Record of Emergency Training Provided - For most recent 12-month period.

Training on Emergency Response Plan and Procedures provided to facility key contacts.

Training Date (dd-mm-yyyy) Q2-2013	Print Name of Training Provider: Superior Propane
	Print Name of Instructor: Kirk Gunter
Training Date (dd-mm-yyyy) None	Print Name of Training Provider:
	Print Name of Instructor:
Training Date (dd-mm-yyyy) BNone	Print Name of Training Provider:
	Print Name of Instructor:

Training on the facility's Emergency Management Procedures provided to staff.

Training Date (dd-mm-yyyy) Q2-2013	Print Name of Training Provider: Nikun Patel (Manager)
	Print Name of Instructor: Nikun Patel
Training Date (dd-mm-yyyy) None	Print Name of Training Provider:
	Print Name of Instructor:
Training Date (dd-mm-yyyy) None	Print Name of Training Provider:
	Print Name of Instructor:

On-site specific training provided to certificate holders / persons with Records of Training.

Training Date (dd-mm-yyyy) 30-04-2013	Print Name of Training Provider: FSN Training & Development Inc
	Print Name of Instructor: Leo Alkenbrack cert # T111
Training Date (dd-mm-yyyy) 20-02-2014	Print Name of Training Provider: FSN Training & Development Inc.
	Print Name of Instructor: Leo Alkenbrack cert # T111
Training Date (dd-mm-yyyy)	Print Name of Training Provider:
	Print Name of Instructor:

**Declaration: I am aware that it is an offence to give false information in this document and I hereby declare that the information I have given here is true and complete.**

Name of person completing this form (please print) Yimei Zeng	Official Title Officer
Signature 	Telephone No. 416-356-6616
	Date (dd-mm-yyyy) 26-03-2014



**Technical Standards and Safety Authority**  
www.tssa.org

14th Floor - Centre Tower  
3300 Bloor Street West  
Toronto Ontario M8X 2X4  
Fax: 416.231.4903  
Customer Service: 1.877.682.8772

**Level 1 Risk and Safety Management Plan (RSMP)**  
**Technical Standards and Safety Act**  
Propane Storage and Handling Regulation

**SECTION B: EMERGENCY AND PREPAREDNESS RESPONSE PLAN (cont'd)**

4. Emergency Training Plan for Coming Year

Training on Emergency Response Plan and Procedures provided to facility key contacts.

Target Date (dd-mm-yyyy) 07-04-2014	Print Name of Training Provider: Nikum Patel Please note: Canadian Propane Gas Association
	Print Name of Instructor: Nikum Patel (Previous Manager) has currently developed the course PTI 911-02
Target Date (dd-mm-yyyy) None	Print Name of Training Provider: content and it and its provider is available to be
	Print Name of Instructor: taught in the first month of taking over business
Target Date (dd-mm-yyyy) None	Print Name of Training Provider:
	Print Name of Instructor:

Training on the facility's Emergency Management Procedures provided to staff.

Target Date (dd-mm-yyyy) 08-04-2014	Print Name of Training Provider: Blue Mountain Oil Canada Inc. Key Contact: to train staff
	Print Name of Instructor: Yimei Zeng (Officer)
Target Date (dd-mm-yyyy) None	Print Name of Training Provider:
	Print Name of Instructor:
Target Date (dd-mm-yyyy) None	Print Name of Training Provider:
	Print Name of Instructor:

On-site specific training provided to certificate holders / persons with Records of Training.

Target Date (dd-mm-yyyy) 20-02-2014	Print Name of Training Provider: FSN Training & Development Inc. Please Note - a ROT is valid for 3 years
	Print Name of Instructor: Leo Alkenbrack Cert # T111 Note: To call training provider if any training is required
Target Date (dd-mm-yyyy) None	Print Name of Training Provider: in 2014
	Print Name of Instructor:
Target Date (dd-mm-yyyy) None	Print Name of Training Provider:
	Print Name of Instructor:

**Declaration: I am aware that it is an offence to give false information in this document and I hereby declare that the information I have given here is true and complete.**

Name of person completing this form (please print) Yimei Zeng	Official Title Officer
Signature 	Telephone No. 416-356-6616
	Date (dd-mm-yyyy) 26-03-2014





**Technical Standards and Safety Authority**  
www.tssa.org

14th Floor - Centre Tower  
3300 Bloor Street West  
Toronto Ontario M8X 2X4  
Fax: 416.231.4903  
Customer Service: 1.877.682.8772

**Level 1 Risk and Safety Management Plan (RSMP)**  
*Technical Standards and Safety Act*  
Propane Storage and Handling Regulation

**SECTION B: EMERGENCY AND PREPAREDNESS RESPONSE PLAN (cont'd)**

The licence holder will complete Section B in consultation with the local Fire Services.

5. Emergency Response Communications Plan

**Warnings and Actions**

Describe who gives warnings to whom, and how and when the warning will be given (including public notification as appropriate).  
The operator or Alternate will contact emergency services by calling 911 and will provide warnings outlined in the attached: "Propane Emergency Response Procedures" placard (to be posted on site and part of the employee training). If it is safe to do so this could involve advising neighbors to evacuate. The owner/operator may also contact Superior Propane via the emergency number identified in the ERP.

Describe what action is to be taken and by whom when a warning is issued (including details of a meeting place in a safe identified area and activating the evacuation plan, if necessary).  
The owner /operator or alternate should first follow the actions in the ERP provided herein. Stage evacuation, if the release of propane cannot be stopped by cutting electrical power may be required. Note a specific muster point is not advisable, since a propane plume can blow in any direction.  
Actions will be taken by an on duty ROT person(s)

**Communication with Emergency Response Authorities**

Describe when and how the licence holder will give early warning to emergency response authorities (including a process to ensure that a call is placed to 911).  
When the system is operational, a ROT person will be on duty and be in the propane tank area. This person will be able to visually ascertain any abnormal/accident event and implement the appropriate emergency response actions. When the system is not in operation, the ISC valve (main isolation valve) is closed, and the propane system is unattended. Any accident involving the propane tank during such times will require the intervention of random, nearby individuals.

Describe provisions for fire department entry when there are no operations or staffing at the propane site.  
The propane tank system is located in a wide open area that is easily accessible.  
The fire access routes are identified in the attached site plan.

Describe how the licence holder will ensure continual flow of updated information to authorities.  
The critical information required from the license holder is (a) how to shut the system down and (b) the fill level in the tank (if known)  
Fill level is relevant from a time-to-BLEVE perspective (a near empty tank will BELEVE sooner than a full tank if there is a fire impingement on the tank).  
This information will be provided to the authorities by Key Contact Liang Huang or alternate Yimei Zeng.

How long will it take the facility liaison person to respond to the site.  
Key Contact: 1 hour to arrive at the facility in the event of an emergency

**Declaration: I am aware that it is an offence to give false information in this document and I hereby declare that the information I have given here is true and complete.**

Name of person completing this form (please print) Yimei Zeng	Official Title Officer	
Signature 	Telephone No. 416-356-6616	Date (dd-mm-yyyy) 26-03-2014



**Technical Standards and Safety Authority**  
www.tssa.org

14th Floor - Centre Tower  
3300 Bloor Street West  
Toronto Ontario M8X 2X4  
Fax: 416.231.4903  
Customer Service: 1.877.682.8772

**Level 1 Risk and Safety Management Plan (RSMP)**  
*Technical Standards and Safety Act*  
Propane Storage and Handling Regulation

**SECTION B: EMERGENCY AND PREPAREDNESS RESPONSE PLAN (cont'd)**

The licence holder will complete Section B in consultation with the local Fire Services.

6. Building and Site Security and Procedures

	Yes	No
1. Does the propane location have controlled access to limit unnecessary risk and entry (lock out procedures)?	<input checked="" type="checkbox"/>	<input type="checkbox"/>
2. Is there adequate night lighting at the site?	<input checked="" type="checkbox"/>	<input type="checkbox"/>
3. Are procedures in place that ensure access routes, aisles, storage area, filling areas and the grounds are kept clear from unwanted materials?	<input checked="" type="checkbox"/>	<input type="checkbox"/>
4. Are there procedures that capture and record the daily inspection of hoses and inspection requirements for filling systems and mechanical devices used in the transfer of propane?	<input checked="" type="checkbox"/>	<input type="checkbox"/>
5. Does the facility have procedures that include a process to isolate and purge any overfilled propane cylinders?	<input checked="" type="checkbox"/>	<input type="checkbox"/>
6. Are weighing systems validated for accuracy?	<input checked="" type="checkbox"/>	<input type="checkbox"/>
7. Are storage areas clearly marked with the vessels' capacity status (i.e., filled, empty, purged and other hazardous materials)?	<input checked="" type="checkbox"/>	<input type="checkbox"/>
8. Are quality assurance procedures in place to ensure that all valves are closed after the propane cylinders are filled?(e.g., QCC valves)	<input checked="" type="checkbox"/>	<input type="checkbox"/>
9. Is the schedule of maintenance and testing activities retained on site?	<input checked="" type="checkbox"/>	<input type="checkbox"/>

7. Water Supply

The propane licence holder should work with the local fire department to determine water supply capabilities that are available based on the propane facility's location.

	Yes	No
1. Is a pressurized water system available at the propane facility site?	<input type="checkbox"/>	<input checked="" type="checkbox"/>
2. Can the municipal fire department pump 375 GPM (1420 LPM) of water at this location?	<input checked="" type="checkbox"/>	<input type="checkbox"/>
3. What is the unobstructed distance to the closest water supply that could be used for firefighting activities? (distance in metres only)	<u>66 m fire hydrant</u>	
4. What is the unobstructed distance to the closest approved water supply with year round access if there are no hydrants? ( distance in metres only)	<u>330 m Trent River</u>	

**Declaration: I am aware that it is an offence to give false information in this document and I hereby declare that the information I have given here is true and complete.**

Name of person completing this form (please print) Yimei Zeng	Official Title Officer	
Signature 	Telephone No. 416-356-6616	Date (dd-mm-yyyy) 26-03-2014



**Technical Standards and Safety Authority**  
www.tssa.org

14th Floor - Centre Tower  
3300 Bloor Street West  
Toronto Ontario M8X 2X4  
Fax: 416.231.4903  
Customer Service: 1.877.682.8772

**Level 1 Risk and Safety Management Plan (RSMP)**  
*Technical Standards and Safety Act*  
Propane Storage and Handling Regulation

**SECTION B: EMERGENCY AND PREPAREDNESS RESPONSE PLAN (cont'd)**

The licence holder will complete Section B in consultation with the local Fire Services.

8. Licence holder and local Fire Services Review

**To be completed by the Local Fire Services**

Has the local fire service had an opportunity to review the Emergency Response and Preparedness Plan?

Yes

No

If not, please explain (e.g., no fire services).

[A copy of the Level 1 RSMP will be delivered to the Fire Service for their comments](#)

Fire services comments, if any:

**To be completed by the Licence Holder**

In response to the above comments, the following action(s) is required:

The licence holder will respond to the Local Fire Services comments by: 01-04-2014  
(dd-mm-yyyy)

**LOCAL FIRE SERVICES**

The undersigned has reviewed Section B of the Risk and Safety Management Plan Fire Services.

Print name	Signature	Date (dd-mm-yyyy)
Local Fire Services Name		

**Declaration: I am aware that it is an offence to give false information in this document and I hereby declare that the information I have given here is true and complete.**

Name of person completing this form (please print) Yimei Zeng	Official Title Officer	
Signature 	Telephone No. 416-356-6616	Date (dd-mm-yyyy) 26-03-2014



**Technical Standards and Safety Authority**  
www.tssa.org

14th Floor - Centre Tower  
3300 Bloor Street West  
Toronto Ontario M8X 2X4  
Fax: 416.231.4903  
Customer Service: 1.877.682.8772

**Level 1 Risk and Safety Management Plan (RSMP)**  
*Technical Standards and Safety Act*  
Propane Storage and Handling Regulation

**SECTION C: SUBMISSIONS**

Applicant must include a Facility Site Plan and Map of Surrounding Area

**Facility Site Plan.**

The licence holder will submit a copy of the original facility site plan updated with the following information:

1. The storage location of fixed, portable, and mobile vessels.
2. The maximum volume, types and storage location of hazardous materials.
3. Location of permanent structures on site.
4. Access and egress points and location of barriers.
5. Location of fire and emergency equipment (e.g., sprinkler systems, extinguishers, suppression systems) on site and location of fire hydrant or water supply where available.
6. Location of emergency shut off/shut down switches/valves.

**Map of Surrounding Area.**

The licence holder will submit a scaled aerial map of the surrounding area showing the following information:

7. The capacity and placement of the single largest propane storage vessel, including its setback from the front, rear and side property lines.
8. GPS co-ordinates of the single largest vessel.
9. Visual indication of the single largest fixed vessel and a circle made using the distance in Table 1 as the radius from the single largest fixed vessel.
10. Clear indication of the municipality or municipalities present within the circle.
11. Visual indication of property line information.
12. The location and name of roads within or abutting the site.
13. Key note to the drawing indicating the facility's municipal address, municipal lot number(s) and concession lines as applicable, and the date the map was prepared.
14. Address and contact information for each municipality (municipal clerk or secretary-treasurers of planning board). (Refer to page 5.)
15. Complete "Required Mapping Information from Updated Site Plan" in table below .

**Required Mapping Information from Updated Site Plan**

Date Map Prepared (dd-mm-yyyy) 17-09-2011	Capacity of single largest propane storage vessel (USWG) 2000 uswg
Tank setback coordinates. Indicate placement on the map.	
Front: <u>38 m</u>	Right side property line: <u>45 m</u>
Rear: <u>3 m</u>	Left side property line: <u>15 m</u>
GPS coordinates of single largest vessel: <u>44.1203 -77.5942</u>	

**Declaration: I am aware that it is an offence to give false information in this document and I hereby declare that the information I have given here is true and complete.**

Name of person completing this form (please print) Yimei Zeng	Official Title Officer	
Signature 	Telephone No. 416-356-6616	Date (dd-mm-yyyy) 26-03-2014



**Technical Standards and Safety Authority**  
www.tssa.org

14th Floor - Centre Tower  
3300 Bloor Street West  
Toronto Ontario M8X 2X4  
Fax: 416.231.4903  
Customer Service: 1.877.682.8772

**Level 1 Risk and Safety Management Plan (RSMP)**  
*Technical Standards and Safety Act*  
Propane Storage and Handling Regulation

**SECTION C: SUBMISSIONS (cont'd)**

Applicant must include a Facility Site Plan and Map of Surrounding Area

**Table 1: Distance Table**

Water Capacity (litres)	Nominal Water Capacity (USWG)	Distance to 1 psi overpressure (m)
1,890	500	155
3,780	1,000	195
4,920	1,300	213
6,620	1,750	235
7,130	1,885	241
7,560	2,000	246
18,900	5,000	333

**Formula:**  $D = 16.94 \times (1.524 \times C)^{1/3}$   
D = Distance to overpressure of 1 psi (meters)  
C = Tank Total Capacity in USWG

**Parameters:** Density of Propane is 0.5033 kg per litre @ 15 C  
Assume all vessels are 80% full  
1 gallon [US, liquid] = 0.003785411784 cubic meter  
1 cubic metre = 264.17 USWG

**Hazard Distance Chart (EPA-TNT model)**

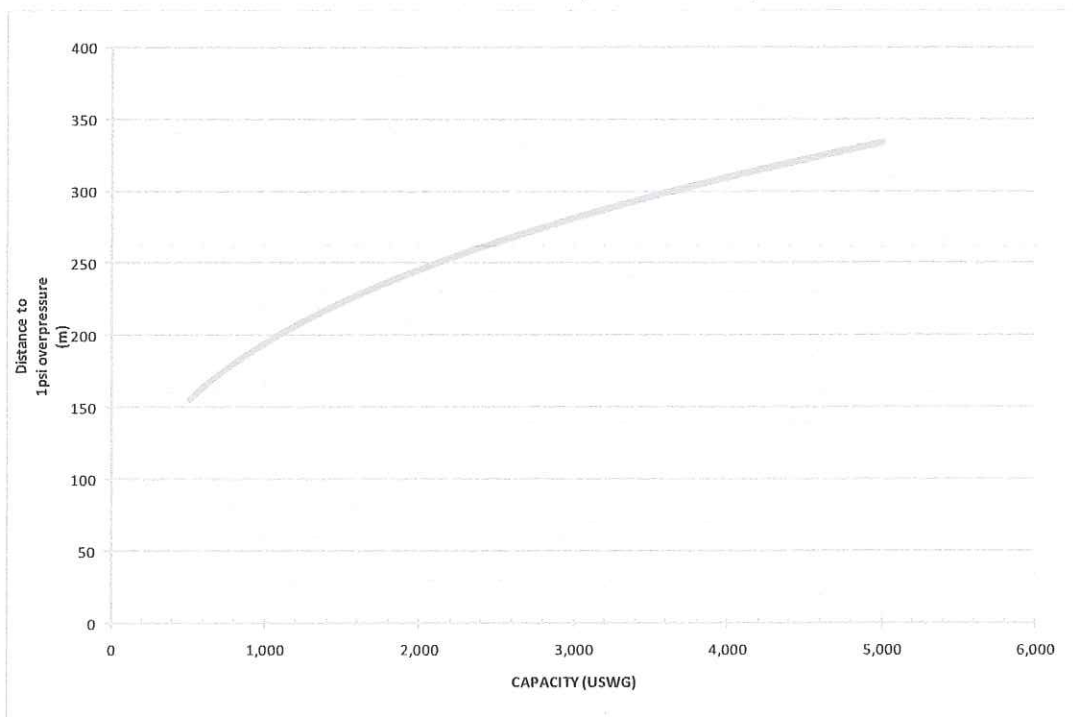

**Declaration: I am aware that it is an offence to give false information in this document and I hereby declare that the information I have given here is true and complete.**

Name of person completing this form (please print) Yimei Zeng	Official Title Officer
Signature <i>Yimei Zeng</i>	Telephone No. 416-356-6616
	Date (dd-mm-yyyy) 20-03-2014



**Technical Standards and Safety Authority**  
www.tssa.org

14th Floor - Centre Tower  
3300 Bloor Street West  
Toronto Ontario M8X 2X4  
Fax: 416.231.4903  
Customer Service: 1.877.682.8772

**Level 1 Risk and Safety Management Plan (RSMP)**  
*Technical Standards and Safety Act*  
Propane Storage and Handling Regulation

**SECTION C: SUBMISSIONS (cont'd)**

Applicant must include a Facility Site Plan and Map of Surrounding Area

As an accompaniment to the Map of Surrounding Area, provide the following information about buildings and features present within the circle in Table 2.

**Table 2: Buildings and Features**

Buildings and Features Present within the Circle on the Map of the Surrounding Area AND Name and Address of Closest Building or Feature	* Number of Buildings and Features (mark with an "X")				Distance from Tank to Closest Building or Feature
	0	1	2-10	11+	
Industrial buildings or parks or golf courses Name: <u>Terry Shorts Electrical Services</u> Address: <u>94 HWY 33 RR# 3</u> City: <u>Trenton</u> Province <u>ON</u> Postal Code <u>K8V 5P6</u>			x		<u>33</u> m
Residential building units specifically permanent single family dwellings, condominiums, and apartments. Name: <span style="background-color: black; color: black;">[REDACTED]</span> Address: <span style="background-color: black; color: black;">[REDACTED]</span> City: <span style="background-color: black; color: black;">[REDACTED]</span>			x		<u>181.5</u> m
Commercial building units specifically retail, restaurants, entertainment, theatres, and sporting complexes. Name: <u>Tim Hortons</u> Address: <u>110 HWY 33 RR# 3</u> City: <u>Trenton</u> Province <u>On</u> Postal Code <u>K8V 5P6</u>		x			<u>24.9</u> m
Commercial building units – continuous occupancy specifically hotels, campgrounds, and resorts. Name: _____ Address: _____ City: _____ Province _____ Postal Code _____	x				<u>0</u> m
Sensitive institutions specifically hospitals, schools and day cares, nursing and retirement homes, mental health institutions, and prisons. Name: _____ Address: _____ City: _____ Province _____ Postal Code _____	x				<u>0</u> m
Emergency responders specifically fire stations, ambulance stations, and police stations. Name: _____ Address: _____ City: _____ Province _____ Postal Code _____	x				<u>0</u> m

\* For multi-unit buildings, count each unit as "1".

**Declaration: I am aware that it is an offence to give false information in this document and I hereby declare that the information I have given here is true and complete.**

Name of person completing this form (please print) <u>Yimei Zeng</u>	Official Title <u>Officer</u>
Signature 	Telephone No. <u>416-356-6616</u>
	Date (dd-mm-yyyy) <u>26-03-2014</u>



**Technical Standards and Safety Authority**  
www.tssa.org

14th Floor - Centre Tower  
3300 Bloor Street West  
Toronto Ontario M8X 2X4  
Fax: 416.231.4903  
Customer Service: 1.877.682.8772

**Level 1 Risk and Safety Management Plan (RSMP)**  
*Technical Standards and Safety Act*  
Propane Storage and Handling Regulation

**SECTION C: SUBMISSIONS (cont'd)**

Applicant must include a Facility Site Plan and Map of Surrounding Area

**Portable Storage Additional Information Sheet**

Cylinder Size	Capacity in USWG	Quantity	Total Volume in USWG
# 420	123.9	0	0
# 100	29.5	0	0
# 40	11.75	0	0
# 33.3	9.62	0	0
# 30	8.8	5	44
# 20	5.8	15	87
# 10	2.9	0	0
# 5	1.5	0	0
<b>Total Cylinder Capacity</b>			<b>131</b>

**Tanks Stored On-site Not Connected for Use**

Tank Size In USWG	Quantity	Total Volume in USWG
0	0	0
<b>Total Tank Capacity</b>		<b>0</b>

<b>Total Cylinder Capacity</b>	<b>131</b>
<b>Total Tank Capacity</b>	<b>2000 USWG</b>
<b>Total Portable Capacity</b>	<b>131</b>

**Declaration: I am aware that it is an offence to give false information in this document and I hereby declare that the information I have given here is true and complete.**

Name of person completing this form (please print) Yimei Zeng	Official Title Officer	
Signature <i>Yimei Zeng</i>	Telephone No. 416-356-6616	Date (dd-mm-yyyy) 26-03-2014

©2011 Flash Earth – Neave Interactive Limited  
 Map data ©2011 Microsoft Corporation, Tele Atlas

Scale (m):

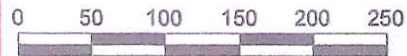

Hazard  
 Distance =  
 246 m

Setback Distances to Site Boundary  
 Northwest : 38 m    Northeast: 45 m  
 Southeast: 3 m    Southwest: 15 m

Capacity of Propane Storage Tank  
 Capacity of Propane Storage Tank = 2000 USWG

GPS Co-ordinates of Propane Storage Tank  
 GPS Co-ordinates = 44.1203, -77.5942

Circular Distance to 1 psi overpressure  
 Denoted by circle centred on tank; radial distance = 246 m

Municipality (ies) within the 1 psi overpressure circle  
 City of Quinte West

Municipal Contact  
 DonnaLee Craig  
 City Clerk, City of Quinte West  
 7 Creswell Drive, P.O. Box 490, Trenton, ON, K8V 5R6  
 Tel: 613-392-2841 ext. 4445 Fax: 613-392-0714  
 Email: donnaleec@quintewest.ca

Map of Surrounding Area

Blue Mountain Oil Canada Inc.  
 110 Highway 33, Trenton, ON, K8V 5P6  
 Part of Lot 4, Concession 2, Geographic Township of  
 Murray now in the County of Northumberland

Drawn by: S. Oliverio      Date: August 17, 2011



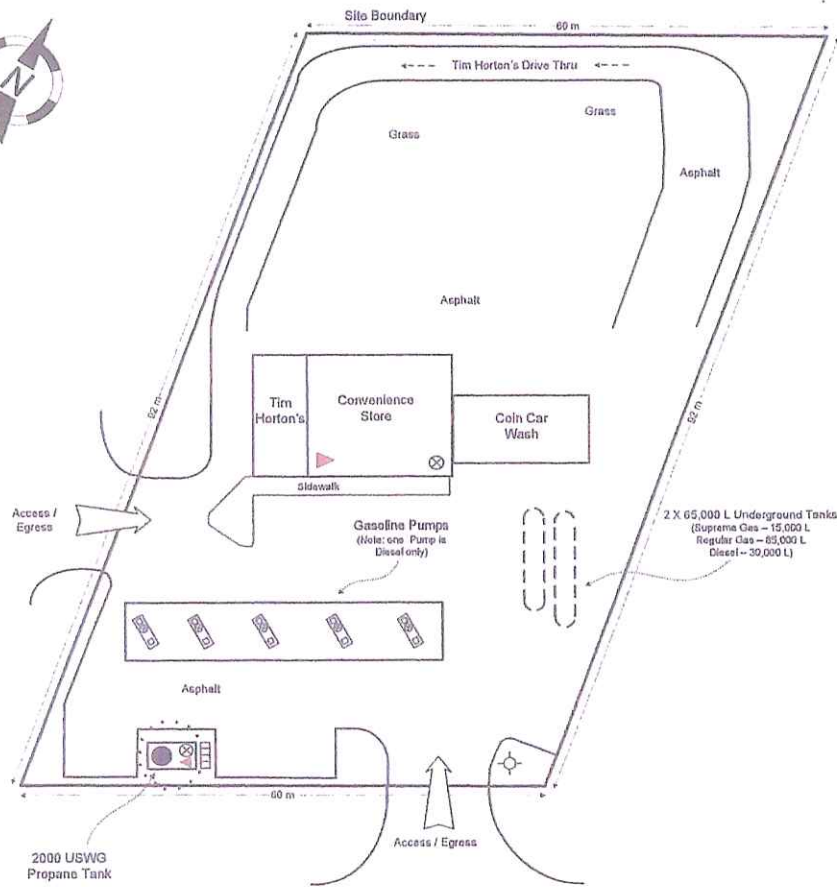

Highway 33



Key Plan:



Notes:

1. Tank distances to property lines:

Property Line Setbacks	Distance
Northwest	38 m
Southeast (Front)	3 m
Northeast	45 m
Southwest	15 m

2. Fire Extinguisher 

3. Egress/Fire Access Route:

Site is wide open, with egress/access from Highway 33 and Coad Road.

4. E-Stop 

Note: The E-Stop in the Convenience store is for the gasoline.

5. Cylinder Cage 

6. Municipal Fire Hydrant 

### FSN Training & Development

Title:

**Site Plan**

1381190 Ontario Ltd.

110 Highway 33, Trenton, ON, K8V 5P6

Part of Lot 4, Concession 2, Geographic Township of Murray  
now in the County of Northumberland

Drawn by: S.Oliverio

Checked by:

Date: August 17, 2011

Rev 0

PLAN OF SURVEY SHOWING TOPOGRAPHICAL DETAIL OF PART OF LOT 4, CONCESSION 2 Geographic Township of Murray Now In The

COUNTY OF NORTHUMBERLAND

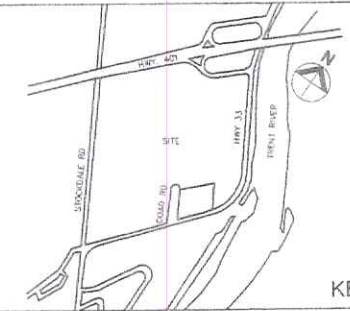

KEY PLAN

NOTE

FOR INFORMATION ON GRADING AND SITE SERVICING REFER TO DRAWINGS PROVIDED BY SERNAS GROUP INC.

PROJECT STATISTICS

LOT(SITE) AREA (m <sup>2</sup> )	5152.5 SQ.M.
PROJECT LOT(SITE) AREA (m <sup>2</sup> )	5152.5 SQ.M.
EXISTING BUILDING	452.8 SQ.M.
BUILDING PORTION TO BE DEMOLISHED	324.0 SQ.M.
NEW CONSTRUCTION AREA	350.5 SQ.M.
NEW COFFEE PARTNER	110.0 SQ.M.
NEW CONVENIENCE STORE	240.5 SQ.M.
TOTAL BUILDING AREA	479.5 SQ.M.
PROPOSED COVERAGE	9.3%
FUTURE CARWASH	129.2 SQ.M.
EXISTING ASPHALT AREA	2767.7 SQ.M.
PROPOSED ASPHALT AREA	3023 SQ.M.
EXISTING GRAVEL AREA TO RETAIN	1100 SQ.M.
PROPOSED LANDSCAPED AREA	550 SQ.M. (10.7%)

NOTE: PROPOSED AREAS DO NOT INCLUDE FUTURE CAR WASH AND AREAS NOTED AS FUTURE DEVELOPMENT.

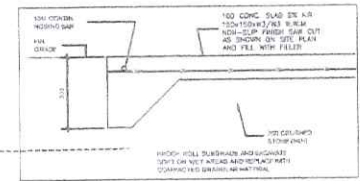
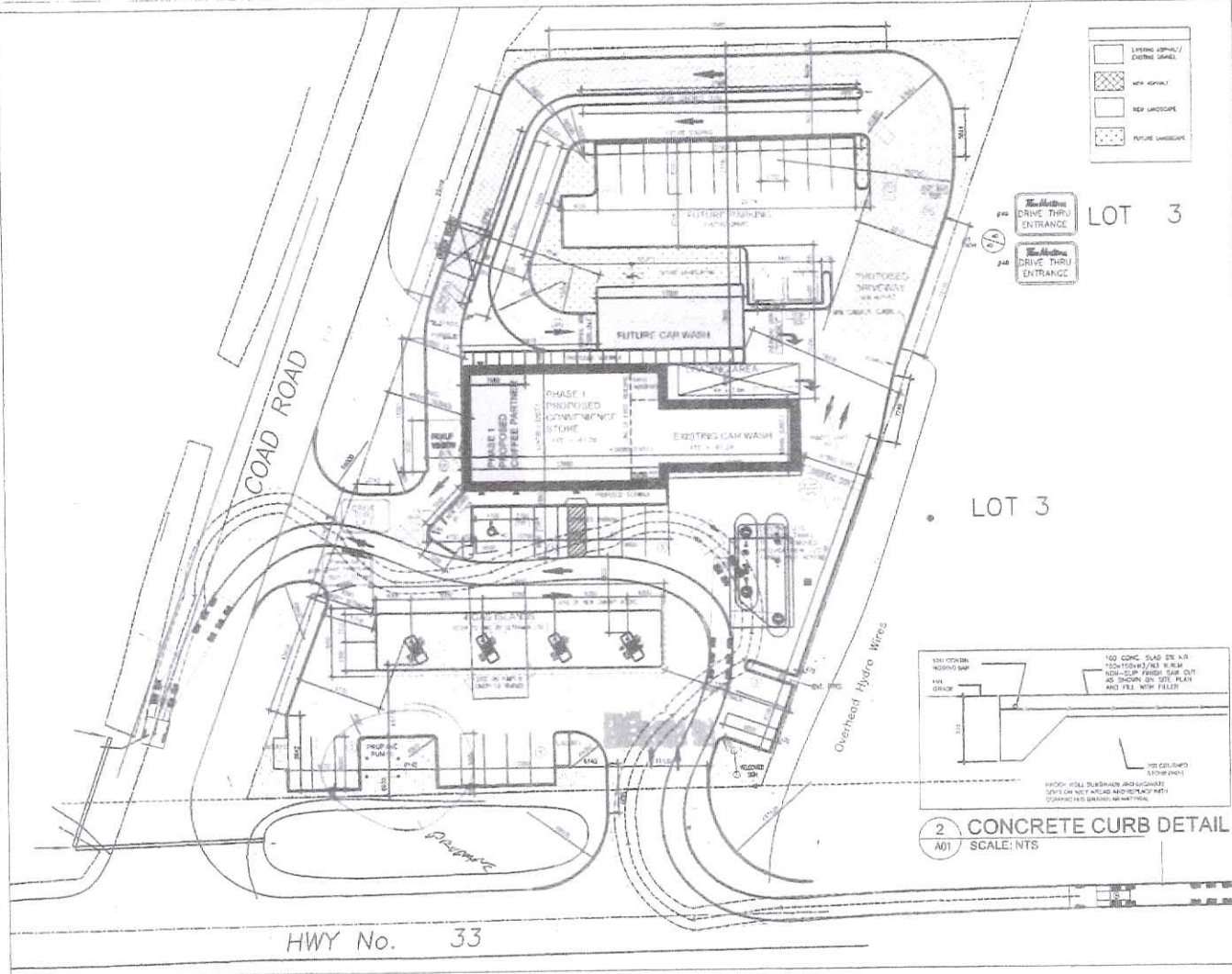

1 PROPOSED SITE PLAN SCALE: 1:500

MICHAEL A. FARIC architect  
388 DUNDAS STREET WEST  
TORONTO, ONTARIO M5G 1K4  
Tel: 416 597-1527 Fax: 416 597-1528  
E-Mail: info@mfaarchitect.com



REFERENCE DRAWINGS	ISSUE	REVISIONS	DRAWN BY:	SCALE:	PROJECT NORTH
			SD	NTS	
			ME		
DWG NO.	TITLE	ISS	DATE	ISSUED FOR	REVI DATE
1	01.29.10	ISSUED FOR BUILDING PERMIT			

SCALE: NTS  
PROJECT NORTH

110 COUNTY ROAD 33  
PROPOSED ULTRAMAR GAS,  
CONVENIENCE STORE & COFFEE PARTNER  
QUINTE WEST, ONTARIO  
PROPOSED SITE PLAN

PROJECT NO.	DWG. NO.	REV.	SHEET
290119		0	A01

Blue Monutain Oil (Canada) Inc.110 HWY # 33 RR# 3 Trenton, ON K8N 4Z2

Section B - Emergency and Preparedness Response Plan – Appendix

Question 1: Controlled Access to propane filling station (Yes)

Posts used to protect from vehicular traffic (Yes)

Cabinet is closed and locked when filling station not in use. (Yes)

Question 2: Adequate Night Lighting

Site has have night lighting (Yes)

Question 3: Procedures for keeping access routes etc. clear

Included in Superior Propane Daily Start-up Procedures for Operating a Transfer Facility (Yes)

Question 4: Procedures for inspecting hoses and equipment

Included in Superior Propane Daily Start-up Procedures for Operating a Transfer Facility (Yes)

Part of PTI Propane Pump Attendant training module (Yes)

Question 5: Procedures for isolating and purging any overfilled cylinders

Appendix E of Superior Propane “Propane Dispenser Operating Procedures” (Yes)

Question 6: Validating weighing systems for accuracy

Daily scale check included as part of PTI Propane Pump Attendant training manual

Annual check completed by \_\_Staff & Superior Propane & Measurement Canada (Yes)

Question 7: Storage Areas marked for “empties”, “fulls” & other hazardous materials (Yes)

Operator to provide signage (Yes)

Question 8: Quality Assurance Procedures to ensure that valves are closed after filling

Valve closure step included in PTI Propane Pump Attendant training manual (Yes)

Question 9: Schedule of Maintenance and Testing Activities

Maintenance and Testing schedule on Pg 4 of RSMP

Superior Propane completes annual inspection (Yes)

Testing included as part of S.I.P Dispenser Operating Procedures (Yes)