



Technical Standards and Safety Authority
www.tssa.org

14th Floor - Centre Tower
3300 Bloor Street West
Toronto Ontario M8X 2X4
Fax: 416.231.4078
Customer Service: 1.877.682.8772

Level 1 Risk and Safety Management Plan (RSMP)
Technical Standards and Safety Act
Propane Storage and Handling Regulation

This Level 1 RSMP applies to:
 • a facility with a total propane storage capacity of 5,000 USWG or less; or
 • a facility with a fixed propane storage capacity of exactly 5,000 USWG and no more than 500 USWG of portable propane storage capacity on site.

Failure to fully complete this form may result in rejection. Making a false statement may result in a fine or prosecution under the *Technical Standards and Safety Act*

Licence Number 0076389907-C (Existing)

Check applicable type of propane operations.

Cylinder Motor Fill Filling Plant Card/Keylock

Submit along with this completed application a Facility Site Plan and a Map of the Surrounding Area.

For Office Use Only

Intake Group

SR: [Redacted]

SECTION A: GENERAL INFORMATION

The Undersigned applies to TSSA for a review for an RSMP under Ontario's *Technical Standards and Safety Act*, Propane Storage and Handling Regulation.

A Company Name 9290141 Canada Inc. Corporation No. 9290141

Operator Name (if different from above) Ola Gino's Gas Bar

Telephone No. (519)-763-2940 Fax No. n/a E-mail mkharodia@gmail.com

B Street No. 352 Street Name / 911 Number / Address, if applicable Elizabeth Street

Town / City or Township / County Guelph Province Ontario Postal Code N1E 2X7

C Mailing address if different from above.

Street No. 352 Street Name / 911 Number / Address, if applicable Elizabeth Street

Town / City or Township / County Guelph Province Ontario Postal Code N1E 2X7

Information on Container Refill Centre or Filling Plant

D Location of facility.

Street No. 352 Street Name / 911 Number / Address, if applicable Elizabeth Street Nearest Major Intersection Elizabeth Street & Victoria Road

Town / City or Township / County Guelph Province Ontario Postal Code N1E 2X7

Name of Licence Holder Mehbub Kharodia

Name of a Senior Management person as defined in the regulation holding the Record of Training (ROT). Mehbub Kharodia ROT type 100-08

Municipality (or municipalities if the facility or its hazard distance touches multiple borders) Guelph

Hours of operation. [Redacted]

This document is valid until the next licence renewal date. You are required by law to notify TSSA of any change of information.

Declaration: I am aware that it is an offence to give false information in this document and I hereby declare that the information I have given here is true and complete.

Print name	Signature	Date (dd-mmm-yyyy)
Name of Licence Holder <u>Mehbub Kharodia</u>		<u>30-06-2015</u>
Name of Senior Management person as defined in the Regulation holding the Record of Training <u>Mehbub Kharodia</u>		<u>30-06-2015</u>



Technical Standards and Safety Authority
www.tssa.org

14th Floor - Centre Tower
3300 Bloor Street West
Toronto Ontario M8X 2X4
Fax: 416.231.4078
Customer Service: 1.877.682.8772

Level 1 Risk and Safety Management Plan (RSMP)
Technical Standards and Safety Act
Propane Storage and Handling Regulation

SECTION A: GENERAL INFORMATION (cont'd)

Indicate the year the facility was established. 1995 Indicate the year of any significant modifications, as defined in s.1, O.Reg 211/01, since establishment.
No significant Changes have taken place

Identify the psig rating and serial number for each fixed propane storage tank on site.

	PSIG	Serial Number
Tank 1:	<u>250</u>	<u>309-99</u>
Tank 2:	_____	_____
Tank 3:	_____	_____

Enter capacity of propane in USWG, fixed, portable, and mobile, and provide detailed inventory that includes the number of tank/vessel for each type (fixed, portable, and mobile) and the capacity of each tank/vessel, on a separate document.

Fixed: 2000 USWG Portable: 139.2 USWG Mobile: 0 USWG

Declaration: I am aware that it is an offence to give false information in this document and I hereby declare that the information I have given here is true and complete.

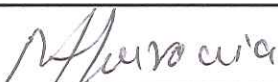
Name of person completing this form (please print) <u>Mehubub Kharodia</u>	Official Title <u>Manager</u>
Signature 	Telephone No. <u>1-519-763-2940</u>
	Date (dd-mmm-yyyy) <u>30-06-2015</u>



Technical Standards and Safety Authority
www.tssa.org

14th Floor - Centre Tower
3300 Bloor Street West
Toronto Ontario M8X 2X4
Fax: 416.231.4078
Customer Service: 1.877.682.8772

Level 1 Risk and Safety Management Plan (RSMP)
Technical Standards and Safety Act
Propane Storage and Handling Regulation

SECTION A: GENERAL INFORMATION (cont'd)

Activity Information

Name of Propane Supplier(s) Primemax Energy Inc.		For Office Use - Party No.	
Street No. 2558	Street Name / 911 Number / Address, if applicable Cedar Creek Road R.R. #1		
Town / City or Township / Country Ayr		Province Ontario	Postal Code N0B 1E0
Telephone No. 1-519-740-8209	Fax No. 1-519-740-1015	Contact Name Mike Taylor	
E-mail primemax@primemaxenergy.com			

Name of Propane Transporter. If same as above, please check box. <input checked="" type="checkbox"/>		For Office Use - Party No.	
Street No.	Street Name / 911 Number / Address, if applicable		
Town / City or Township / Country		Province	Postal Code
Telephone No.	Fax No.	Contact Name	
E-mail			

Off-site Cylinder and/or Mobile Storage	Capacity stored off-site, in USWG	For Office Use - Party No.	
Street No.	Street Name / 911 Number / Address, if applicable		
Town / City or Township / Country		Province	Postal Code
Telephone No.	Fax No.	Contact Name	

Note: Customer storage is not considered off-site storage.

Declaration: I am aware that it is an offence to give false information in this document and I hereby declare that the information I have given here is true and complete.

Name of person completing this form (please print) Mehub Kharodia	Official Title Manager	
Signature 	Telephone No. 1-519-763-2940	Date (dd-mmm-yyyy) 30-06-2015



Technical Standards and Safety Authority
www.tssa.org

14th Floor - Centre Tower
3300 Bloor Street West
Toronto Ontario M8X 2X4
Fax: 416.231.4078
Customer Service: 1.877.682.8772

Level 1 Risk and Safety Management Plan (RSMP)
Technical Standards and Safety Act
Propane Storage and Handling Regulation

SECTION B: EMERGENCY AND PREPAREDNESS RESPONSE PLAN

The licence holder will complete Section B in consultation with the local Fire Services.

Description of the maximum volume, types and storage location of other hazardous materials on site, if any.

The site has 1x2000 USWG horizontal propane tank, 1x20lb cylinder for purging and 1x24 cylinder cage. Facility also has underground storage tanks

1x35,000 foe Regular, 1x13,600 litre for Premium and 1x13,600 litre for Diesel. All underground tanks are fiberglass double walled protected. There are small amounts of lubricants and cleaning products used in the transmission repair shop located on the site, but amounts are minimal.

Description of fire and emergency equipment indicated on facility site map.

The facility is equipped with fire extinguishers. There is one located at the propane tank and two located at the gasoline island.

There is a remote Emergency Shut down (ESD) located on one of the posts near the tank. The ESD kills power to the propane and stops the motor and closes the fuel supply solenoid valve to prevent product flow.

List of fire protection controls (e.g., fire detection systems, fire notification systems, alarm systems, automatic shut off devices, fusible links, etc.) and describe their function, use and operation.

The propane tank is equipped with a fusible link connected to a chain that will melt at 212 degrees F which will break the chain and the spring loaded ISC valve will close automatically shutting off the propane suction to the pump. There is an Emergency Shut Down (ESD) located on one of the posts near the tank. The ESD kills power to the propane and stops the motor and closes the fuel supply solenoid valve to prevent product flow.

There are no alarm systems or detection devices on site.

Maintenance and testing schedule for fire protection controls and devices.

The fire extinguishers are checked monthly and retested annually for proper operation. The propane equipment and ESD is inspected annually by a TSSA registered contractor. Copies of Inspection reports are keep on site.

Declaration: I am aware that it is an offence to give false information in this document and I hereby declare that the information I have given here is true and complete.

Name of person completing this form (please print) Mehbub Kharodia	Official Title Manager	
Signature 	Telephone No. 1-519-763-2940	Date (dd-mmm-yyyy) 30-06-2015



SECTION B: EMERGENCY AND PREPAREDNESS RESPONSE PLAN (cont'd)

1. Contacts for Emergency Response

1. Facility Contact Personnel - Key Contact		5. Facility 24-Hour Contact Person	
Name Mehub Kharodia	For Office Use - Party No.	Name Mehub Kharodia	For Office Use - Party No.
Official Title Manager		Official Title Manager	
Telephone No. 1-519-763-2940	Fax No. n/a	Cell No. 1-519-721-7267	Fax No. n/a
E-mail mkharodia@gmail.com		E-mail mkharodia@gmail.com	
Role and responsibilities in emergency Ensures that all employees are trained to work with propane and enforces the site Emergency Plan in response to emergencies. Will make 911 call.		Role and responsibilities in emergency Same as Item 1	
2. Facility Contact Personnel - Alternate Contact		6. Name of Facility Manager	
Name Gulam Jakda	For Office Use - Party No.	Name Mehub Kharodia	For Office Use - Party No.
Official Title Assistant Manager		Official Title Manager	
Telephone No. 1-519-241-2540	Fax No. n/a	Telephone No. 1-519-763-2940	Fax No. n/a
E-mail mkharodia@gmail.com		E-mail mkharodia@gmail.com	
Role and responsibilities in emergency Will assist the key contact in emergencies and will assume responsibility for site liason if the key contact is away from the site. Will make 911 call.		Role and responsibilities in emergency Same as Item 1	
3. Local Fire Services - Key Contact		7. Propane Supplier Key Contact Person	
Name John Osbourne	For Office Use - Party No.	Name Mike Taylor	For Office Use - Party No.
Official Title Fire Chief	E-mail john.osbourne@guelph.ca	Official Title General Manager	E-mail mtaylor@primemaxenergy.com
Telephone No. 1-519-824-6590 x2140	Fax No. 1-519-824-2147	Telephone No. 1-519-740-8209	Fax No. 1-519-740-1015
Role and responsibilities in emergency Coordinates all Fire Prevention Officers activities and assigns the resources as required during emergencies.		Role and responsibilities in emergency Coordinates truck deliveries and would initiate the CPA Emergency Reponse Plan as required.	
Fire Services Address Guelph Fire Services, 50 Wyndham Street S ,Guelph,Ontario N1H 4E1		Propane Supplier Address Primemax Energy Inc. 2558 Cedar Creek Rd.,RR#1,Ayr,Ontario NOB 1E0	
4. Local Fire Services - Alternate Contact		8. Municipal Contact	
Name Linda Dickson	For Office Use - Party No.	Name James N. Riddell	For Office Use - Party No.
Official Title Manager /CEMC	E-mail lindad@wellington.ca	Official Title General Manager Planning and Building Services	
Telephone No. 1-519-846-8058	Fax No. 1-519-824-2147	Telephone No. 1-519-837-5616	Fax No. 1-519-822-4632
Role and responsibilities in emergency Community Emergency Management Coordinator for Guelph/Eramosa Township. Works with Guelph Fire Department staff in emergencies.		E-mail jim.riddell@guelph.ca	
Fire Services Address County of Wellington, 474 Wellington Rd 18, Suite 20, Fergus, ON. N1M 0A1		Municipality Name and Address City of Guelph, 1 Carden Street, Guelph, Ontario N1H 3A1	

Declaration: I am aware that it is an offence to give false information in this document and I hereby declare that the information I have given here is true and complete.

Name of person completing this form (please print) Mehub Kharodia	Official Title Manager
Signature 	Telephone No. 1-519-763-2940
	Date (dd-mmm-yyyy) 30-06-2015



Technical Standards and Safety Authority
www.tssa.org

14th Floor - Centre Tower
3300 Bloor Street West
Toronto Ontario M8X 2X4
Fax: 416.231.4078
Customer Service: 1.877.682.8772

Level 1 Risk and Safety Management Plan (RSMP)
Technical Standards and Safety Act
Propane Storage and Handling Regulation

SECTION B: EMERGENCY AND PREPAREDNESS RESPONSE PLAN (cont'd)

2. Additional Safety Measures

Describe any other measures in place at the facility that exceed the minimum Code and Standards requirements.

Emergency Response Assistance Plan-available by contacting supplier.

The facility is built to the propane code requirements and does not have any extra features that are over and above the code. The tank is protected with concrete filled steel culvert pipe on all sides and has an Emergency shutdown button that will kill power to the pump and solenoid valve when pushed.

Tank is in constant site of employees on the premises. Fire Equipment access is easy with a large area to manoeuvre trucks around.

Declaration: I am aware that it is an offence to give false information in this document and I hereby declare that the information I have given here is true and complete.

Name of person completing this form (please print) Mehub Kharodia	Official Title Manager	
Signature 	Telephone No. 1-519-763-2940	Date (dd-mmm-yyyy) 30-06-2015



Technical Standards and Safety Authority
www.tssa.org

14th Floor - Centre Tower
3300 Bloor Street West
Toronto Ontario M8X 2X4
Fax: 416.231.4078
Customer Service: 1.877.682.8772

Level 1 Risk and Safety Management Plan (RSMP)
Technical Standards and Safety Act
Propane Storage and Handling Regulation

SECTION B: EMERGENCY AND PREPAREDNESS RESPONSE PLAN (cont'd)

3. Record of Emergency Training Provided - For most recent 12-month period.

Training on Emergency Response Plan and Procedures provided to facility key contacts.

Training Date (dd-mmm-yyyy) 03-07-2015	Print Name of Training Provider: Promar Petroleum Inc.
	Print Name of Instructor: Mike Martin
Training Date (dd-mmm-yyyy)	Print Name of Training Provider:
	Print Name of Instructor:
Training Date (dd-mmm-yyyy)	Print Name of Training Provider:
	Print Name of Instructor:

Training on the facility's Emergency Management Procedures provided to staff.

Training Date (dd-mmm-yyyy) 03-07-2015	Print Name of Training Provider: Promar Petroleum Inc.
	Print Name of Instructor: Mike Martin
Training Date (dd-mmm-yyyy)	Print Name of Training Provider:
	Print Name of Instructor:
Training Date (dd-mmm-yyyy)	Print Name of Training Provider:
	Print Name of Instructor:

On-site specific training provided to certificate holders / persons with Records of Training.

Training Date (dd-mmm-yyyy) 03-07-2015	Print Name of Training Provider: Promar Petroleum Inc.
	Print Name of Instructor: Mike Martin
Training Date (dd-mmm-yyyy)	Print Name of Training Provider:
	Print Name of Instructor:
Training Date (dd-mmm-yyyy)	Print Name of Training Provider:
	Print Name of Instructor:

Declaration: I am aware that it is an offence to give false information in this document and I hereby declare that the information I have given here is true and complete.

Name of person completing this form (please print) Mehbub Kharodia	Official Title Manager
Signature 	Telephone No. 1-519-763-2940
	Date (dd-mmm-yyyy) 30-06-2015



Technical Standards and Safety Authority
www.tssa.org

14th Floor - Centre Tower
3300 Bloor Street West
Toronto Ontario M8X 2X4
Fax: 416.231.4078
Customer Service: 1.877.682.8772

Level 1 Risk and Safety Management Plan (RSMP)
Technical Standards and Safety Act
Propane Storage and Handling Regulation

SECTION B: EMERGENCY AND PREPAREDNESS RESPONSE PLAN (cont'd)

4. Emergency Training Plan for Coming Year

Training on Emergency Response Plan and Procedures provided to facility key contacts.

Target Date (dd-mmm-yyyy) TBD	Print Name of Training Provider: Promar Petroleum Inc.
	Print Name of Instructor: Mike Martin
Target Date (dd-mmm-yyyy)	Print Name of Training Provider:
	Print Name of Instructor:
Target Date (dd-mmm-yyyy)	Print Name of Training Provider:
	Print Name of Instructor:

Training on the facility's Emergency Management Procedures provided to staff.

Target Date (dd-mmm-yyyy) TBD	Print Name of Training Provider: Promar Petroleum Inc.
	Print Name of Instructor: Mike Martin
Target Date (dd-mmm-yyyy)	Print Name of Training Provider:
	Print Name of Instructor:
Target Date (dd-mmm-yyyy)	Print Name of Training Provider:
	Print Name of Instructor:

On-site specific training provided to certificate holders / persons with Records of Training.

Target Date (dd-mmm-yyyy) TBD	Print Name of Training Provider: Promar Petroleum Inc.
	Print Name of Instructor: Mike Martin
Target Date (dd-mmm-yyyy)	Print Name of Training Provider:
	Print Name of Instructor:
Target Date (dd-mmm-yyyy)	Print Name of Training Provider:
	Print Name of Instructor:

Declaration: I am aware that it is an offence to give false information in this document and I hereby declare that the information I have given here is true and complete.

Name of person completing this form (please print) Mehbub Kharodia	Official Title Manager
Signature 	Telephone No. 1-519-763-2940
	Date (dd-mmm-yyyy) 30-06-2015



SECTION B: EMERGENCY AND PREPAREDNESS RESPONSE PLAN (cont'd)

The licence holder will complete Section B in consultation with the local Fire Services.

5. Emergency Response Communications Plan

Warnings and Actions

Describe who gives warnings to whom, and how and when the warning will be given (including public notification as appropriate).
The attendant on site will notify the patrons at the propane facility that a problem has occurred after pressing the ESD switch and closing the ISC valve. The patrons will be asked to leave the site and the attendant will proceed to make a 911 call and request fire and police response. the attendant will proceed to notify the transmission repair shop that an emergency situation exists so they can implement their own plan.

Describe what action is to be taken and by whom when a warning is issued (including details of a meeting place in a safe identified area and activating the evacuation plan, if necessary).
After a warning is issued a combined effort to block off the entrance/exits to the site will be made as the propane facility shares the site with one other business.(Gino's Transmission shop). Cones will be set in place across the entrance & exit and the propane attendant will have shut the facility down and direct everyone on site to meet at the "Muster Point"(See Drawing P-101). At this point they will await the arrival of Emergency Responders.

Communication with Emergency Response Authorities

Describe when and how the licence holder will give early warning to emergency response authorities (including a process to ensure that a call is placed to 911).
Once an emergency situation is confirmed at the propane facility, the attendant will call 911 to ask for Fire and Police response. The attendant always carries a cell phone and also has access to a phone inside the service station. A call will be made at any two of the business locations on site.

Describe provisions for fire department entry when there are no operations or staffing at the propane site.
The site is not fenced so access to the site is always available to Emergency Responders from Elizabeth Street. Tank is located at the back of the property and a fire hydrant is right out front of the property on the other side of the street so access is close to the tank. There are no barriers to the tank.

Describe how the licence holder will ensure continual flow of updated information to authorities.
The attendant will always be on site as the site is operational 24/7. When Emergency Responders come to the site the attendant will identify themselves as the person who is responsible for the propane and will communicate directly with the Emergency Responders.

How long will it take the facility liaison person to respond to the site.
15-20 Minutes for the owner if not already on site.

Declaration: I am aware that it is an offence to give false information in this document and I hereby declare that the information I have given here is true and complete.

Name of person completing this form (please print) Mehub Kharodia	Official Title Manager	
Signature 	Telephone No. 1-519-763-2940	Date (dd-mmm-yyyy) 30-06-2015



SECTION B: EMERGENCY AND PREPAREDNESS RESPONSE PLAN (cont'd)

The licence holder will complete Section B in consultation with the local Fire Services.

6. Building and Site Security and Procedures

	Yes	No
1. Does the propane location have controlled access to limit unnecessary risk and entry (lock out procedures)?	<input checked="" type="checkbox"/>	<input type="checkbox"/>
2. Is there adequate night lighting at the site?	<input checked="" type="checkbox"/>	<input type="checkbox"/>
3. Are procedures in place that ensure access routes, aisles, storage area, filling areas and the grounds are kept clear from unwanted materials?	<input checked="" type="checkbox"/>	<input type="checkbox"/>
4. Are there procedures that capture and record the daily inspection of hoses and inspection requirements for filling systems and mechanical devices used in the transfer of propane?	<input checked="" type="checkbox"/>	<input type="checkbox"/>
5. Does the facility have procedures that include a process to isolate and purge any overfilled propane cylinders?	<input checked="" type="checkbox"/>	<input type="checkbox"/>
6. Are weighing systems validated for accuracy?	<input checked="" type="checkbox"/>	<input type="checkbox"/>
7. Are storage areas clearly marked with the vessels' capacity status (i.e., filled, empty, purged and other hazardous materials)?	<input checked="" type="checkbox"/>	<input type="checkbox"/>
8. Are quality assurance procedures in place to ensure that all valves are closed after the propane cylinders are filled?(e.g., QCC valves)	<input checked="" type="checkbox"/>	<input type="checkbox"/>
9. Is the schedule of maintenance and testing activities retained on site?	<input checked="" type="checkbox"/>	<input type="checkbox"/>

7. Water Supply

The propane licence holder should work with the local fire department to determine water supply capabilities that are available based on the propane facility's location.

	Yes	No
1. Is a pressurized water system available at the propane facility site?	<input checked="" type="checkbox"/>	<input type="checkbox"/>
2. Can the municipal fire department pump 375 GPM (1420 LPM) of water at this location?	<input checked="" type="checkbox"/>	<input type="checkbox"/>
3. What is the unobstructed distance to the closest water supply that could be used for firefighting activities? (distance in metres only)	<u>59 m</u>	
4. What is the unobstructed distance to the closest approved water supply with year round access if there are no hydrants? (distance in metres only)	<u>N/A</u>	

Declaration: I am aware that it is an offence to give false information in this document and I hereby declare that the information I have given here is true and complete.

Name of person completing this form (please print) Mehbub Kharodia	Official Title Manager	
Signature 	Telephone No. 1-519-763-2940	Date (dd-mmm-yyyy) 30-03-2015

Ginos Gas Bar

Ginos Gas Bar
352 Elizabeth Street,
Guelph, ON.
N1E 2X7

July 15, 2015,

Mr. John Osbourne, Fire Chief
Guelph Fire Department
50 Wyndham Street S.,
Guelph, Ontario
N1H 4E1

**Re: Invitation to Fire Services to Review 2000 USWG Propane Tank Installation
9290141 Canada Inc., 352 Elizabeth Street, Guelph, ON. N1E 2X7**

Dear Chief Osbourne:

In regards to your recent review of our Emergency Response and Preparedness Plan related to our existing retail propane tank installation at our facility in Guelph, ON., we appreciate your timely review of the documentation. According to the new Provincial Regulations under Ontario Reg 440/08, we are required to offer the City of Guelph Fire Services an invitation to come and review our installation even though it has been in operation for a number of years now.

We wish to advise you and any members of the City of Guelph Fire Department, they are more than welcome to review our propane dispensing installation at any time that may be convenient to you and your members. The propane installation is already operating as the application to the T.S.S.A. is just for an ownership change however should you or any of the members within your Department or the Community wish to review the installation, we ask you to contact the undersigned at 519.721.7267 to make the necessary arrangements.

If you have any questions regarding this issue, do not hesitate to contact us, and once again, we thank you for your cooperation in helping us to secure our license for this service.

Yours truly,



Mehboob Kharodia, Owner
9290141 Canada Inc.



Technical Standards and Safety Authority
www.tssa.org

14th Floor - Centre Tower
3300 Bloor Street West
Toronto Ontario M8X 2X4
Fax: 416.231.4078
Customer Service: 1.877.682.8772

Level 1 Risk and Safety Management Plan (RSMP)
Technical Standards and Safety Act
Propane Storage and Handling Regulation

SECTION B: EMERGENCY AND PREPAREDNESS RESPONSE PLAN (cont'd)

The licence holder will complete Section B in consultation with the local Fire Services.

8. Licence holder and local Fire Services Review

To be completed by the Local Fire Services

Has the local fire service had an opportunity to review the Emergency Response and Preparedness Plan?

Yes

No

If not, please explain (e.g., no fire services).

Fire services comments, if any:

To be completed by the Licence Holder

In response to the above comments, the following action(s) is required:

The licence holder will respond to the Local Fire Services comments by: _____

(dd-mmm-yyyy)

LOCAL FIRE SERVICES

The undersigned has reviewed Section B of the Risk and Safety Management Plan Fire Services.

Print name	Signature	Date (dd-mmm-yyyy)
Local Fire Services Name John Osbourne- Fire Chief		03-07-2015

Declaration: I am aware that it is an offence to give false information in this document and I hereby declare that the information I have given here is true and complete.

Name of person completing this form (please print) Mehub Kharodia	Official Title Manager	
Signature 	Telephone No. 1-519-763-2940	Date (dd-mmm-yyyy) 30-06-2015



SECTION C: SUBMISSIONS

Applicant must include a Facility Site Plan and Map of Surrounding Area

Facility Site Plan.

The licence holder will submit a copy of the original facility site plan updated with the following information:

1. The storage location of fixed, portable, and mobile vessels.
2. The maximum volume, types and storage location of hazardous materials.
3. Location of permanent structures on site.
4. Access and egress points and location of barriers.
5. Location of fire and emergency equipment (e.g., sprinkler systems, extinguishers, suppression systems) on site and location of fire hydrant or water supply where available.
6. Location of emergency shut off/shut down switches/valves.

Map of Surrounding Area.

The licence holder will submit a scaled aerial map of the surrounding area showing the following information:

7. The capacity and placement of the single largest propane storage vessel, including its setback from the front, rear and side property lines.
8. GPS co-ordinates of the single largest vessel.
9. Visual indication of the single largest fixed vessel and a circle made using the distance in Table 1 as the radius from the single largest fixed vessel.
10. Clear indication of the municipality or municipalities present within the circle.
11. Visual indication of property line information.
12. The location and name of roads within or abutting the site.
13. Key note to the drawing indicating the facility's municipal address, municipal lot number(s) and concession lines as applicable, and the date the map was prepared.
14. Address and contact information for each municipality (municipal clerk or secretary-treasurers of planning board). (Refer to page 5.)
15. Complete "Required Mapping Information from Updated Site Plan" in table below .

Required Mapping Information from Updated Site Plan

Date map prepared (dd-mmm-yyyy) 30-06-2015	Capacity of single largest propane storage vessel (USWG) 2000 USWG
Tank setback coordinates. Indicate placement on the map.	
Front: <u>27.5 m</u>	Right side property line: <u>43.8 m</u>
Rear: <u>7.6 m</u>	Left side property line: <u>27.8 m</u>
GPS coordinates of single largest vessel: <u>Lat43°33'18.92"N Long80°13'56.11"W</u>	

Declaration: I am aware that it is an offence to give false information in this document and I hereby declare that the information I have given here is true and complete.

Name of person completing this form (please print) J. Ross Keys	Official Title Consultant	
Signature 	Telephone No. 416.526.1405	Date (dd-mmm-yyyy) 30-06-2015



SECTION C: SUBMISSIONS (cont'd)

Applicant must include a Facility Site Plan and Map of Surrounding Area

Table 1: Distance Table

Water Capacity (litres)	Nominal Water Capacity (USWG)	Distance to 1 psi overpressure (m)
1,890	500	155
3,780	1,000	195
4,920	1,300	213
6,620	1,750	235
7,130	1,885	241
7,560	2,000	246
18,900	5,000	333

Formula: $D = 16.94 \times (1.524 \times C)^{1/3}$
 D = Distance to overpressure of 1 psi (meters)
 C = Tank Total Capacity in USWG

Parameters: Density of Propane is 0.5033 kg per litre @ 15 C
 Assume all vessels are 80% full
 1 gallon [US, liquid] = 0.003785411784 cubic meter
 1 cubic metre = 264.17 USWG

Hazard Distance Chart (EPA-TNT model)

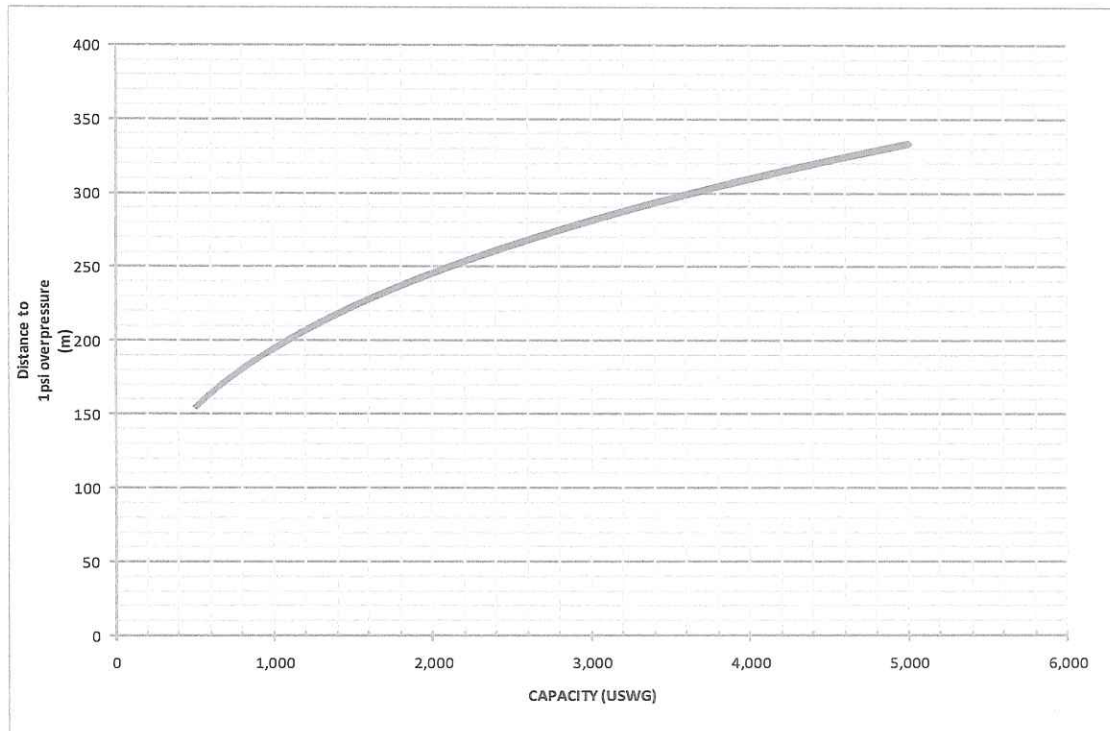



Technical Standards and Safety Authority
www.tssa.org

14th Floor - Centre Tower
3300 Bloor Street West
Toronto Ontario M8X 2X4
Fax: 416.231.4078
Customer Service: 1.877.682.8772

Level 1 Risk and Safety Management Plan (RSMP)
Technical Standards and Safety Act
Propane Storage and Handling Regulation

SECTION C: SUBMISSIONS (cont'd)
Applicant must include a Facility Site Plan and Map of Surrounding Area

As an accompaniment to the Map of Surrounding Area, provide the following information about buildings and features present within the circle in Table 2.

Table 2: Buildings and Features

Buildings and Features Present within the Circle on the Map of the Surrounding Area AND Name and Address of Closest Building or Feature	* Number of Buildings and Features (mark with an "X")				Distance from Tank to Closest Building or Feature
	0	1	2-10	11+	
Industrial buildings or parks or golf courses Name: <u>Independent Paper Convertors</u> Address: <u>309 Elizabeth Street</u> City: <u>Guelph</u> Province <u>Ontario</u> Postal Code <u>N1E 2X8</u>				X	<u>63</u> m
Residential building units specifically permanent single family dwellings, condominiums, and apartments. Name: [REDACTED] Address: [REDACTED] City: [REDACTED]				X	<u>100</u> m
Commercial building units specifically retail, restaurants, entertainment, theatres, and sporting complexes. Name: <u>Gino's Transmission Repair</u> Address: <u>352 Elizabeth Street</u> City: <u>Guelph</u> Province <u>Ontario</u> Postal Code <u>N1E 2X7</u>				X	<u>18</u> m
Commercial building units – continuous occupancy specifically hotels, campgrounds, and resorts. Name: _____ Address: _____ City: _____ Province _____ Postal Code _____	X				<u>67</u> m
Sensitive institutions specifically hospitals, schools and day cares, nursing and retirement homes, mental health institutions, and prisons. Name: _____ Address: _____ City: _____ Province _____ Postal Code _____	X				_____ m
Emergency responders specifically fire stations, ambulance stations, and police stations. Name: <u>City of Guelph Fire Hall No.5</u> Address: <u>corner of Elizabeth Street & Victoria Road</u> City: <u>Guelph</u> Province <u>Ontario</u> Postal Code _____		X			<u>3,900</u> m <u>3.9km</u>

*↪ google map
RF*

* For multi-unit buildings, count each unit as "1".

Declaration: I am aware that it is an offence to give false information in this document and I hereby declare that the information I have given here is true and complete.

Name of person completing this form (please print) <u>J. Ross Keys</u>	Official Title <u>Consultant</u>
Signature 	Telephone No. <u>416-526-1405</u> Date (dd-mmm-yyyy) <u>30-06-2015</u>



Technical Standards and Safety Authority
www.tssa.org

14th Floor - Centre Tower
3300 Bloor Street West
Toronto Ontario M8X 2X4
Fax: 416.231.4078
Customer Service: 1.877.682.8772

Level 1 Risk and Safety Management Plan (RSMP)
Technical Standards and Safety Act
Propane Storage and Handling Regulation

WORKSHEET

Portable Storage Additional Information Worksheet

Cylinder Size	Capacity in USWG	Quantity	Total Volume in USWG
# 420	123.9		
# 100	29.5		
# 40	11.75		
# 33.3	9.62		
# 30	8.8		
# 20	5.8	24	139.2 USWG
# 10	2.9		
# 5	1.5		
Total Cylinder Capacity			139.2 USWG

Tanks Stored On-site Not Connected for Use

Tank Size In USWG	Quantity	Total Volume in USWG
Total Tank Capacity		

Total Cylinder Capacity	139.2 USWG
Total Tank Capacity	2000 USWG
Total Portable Capacity (Total Cylinder Capacity + Total Tank Capacity)	2139.2 USWG



KEY PLAN
SCALE: N.T.S.

NOTES:

CONSEQUENCE DISTANCE TO AN OVERPRESSURE LEVEL OF 1 psf BASED ON TNT-EQUIVALENCY METHOD, AS PER T.S.S.A. GUIDELINES FOR THE IMPLEMENTATION OF THE RISK AND SAFETY MANAGEMENT PLAN

$$D = 17 \times \left(0.1 \times W_p \times \frac{HC_f}{HC_{TNT}} \right)^{1/3} = 246m$$

PROPERTY LINE SETBACKS	
NORTH	7.6m
SOUTH	27.5m
EAST	43.8m
WEST	27.8m

GPS COORDINATES	
LATITUDE	LONGITUDE
43°33'18.92"N	80°13'56.11"W

AS PER TSSA GUIDELINES FOR THE IMPLEMENTATION OF THE RISK AND SAFETY MANAGEMENT PLAN, THIS FACILITY ONLY REQUIRES A LEVEL 1 RSMF.

PLANNING ADVISORY INFORMATION:

AS PER TSSA ADVISORY REQUIREMENTS, THE FOLLOWING PLANNING INFORMATION IS PROVIDED BELOW:

CITY OF GUELPH
1 CARDEN STREET,
GUELPH, ON. N1H 3A1

ATTN: MR. JAMES N. RIDDELL
PH# 1-519-837-5616
FAX#: 1-519-822-4632
EMAIL: jim.riddell@guelph.ca

1	JUN. 30, '15	ISSUED FOR RSMF OWNERSHIP CHANGE	JRK
0	OCT. 02, '11	ISSUED FOR RSMF APPROVAL	JRK
No.	Date	Description	By

REVISIONS

Gino's Gas Bar

ALTENG Inc.
Alternative Energy Consulting
126 Holm Crescent, Thornhill, Ontario L3T 5J3
Telephone: (905)764-1644 Fax: (905)764-5986

Project: 9290141 CANADA Inc. (o/a Gino's Gas Bar) 352 Elizabeth Street Guelph, ON N1E 2K7	Drawn By: D.F. Checked By: J.R.K. Date: NOV. 09, '11
Drawing Title: BLAST RADIUS LAYOUT 2,000 USWG PROPANE TANK	Drawing Scale: 1:1000
Drawing Number: P-200	File Number: 11510D
ACAD INFORMATION	
Drawing File: 11510D-P-200 Drawing Size: D Plotting Scale: 1=1	

© 2011 Google

Image © 2011 First Base Solutions

© 2010 Google

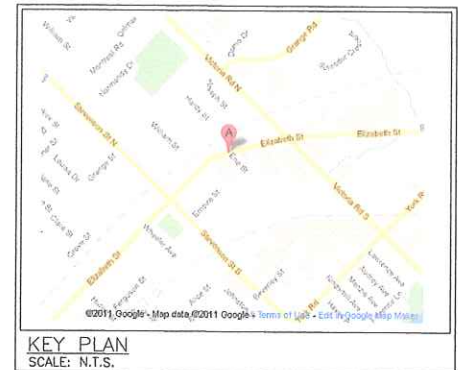
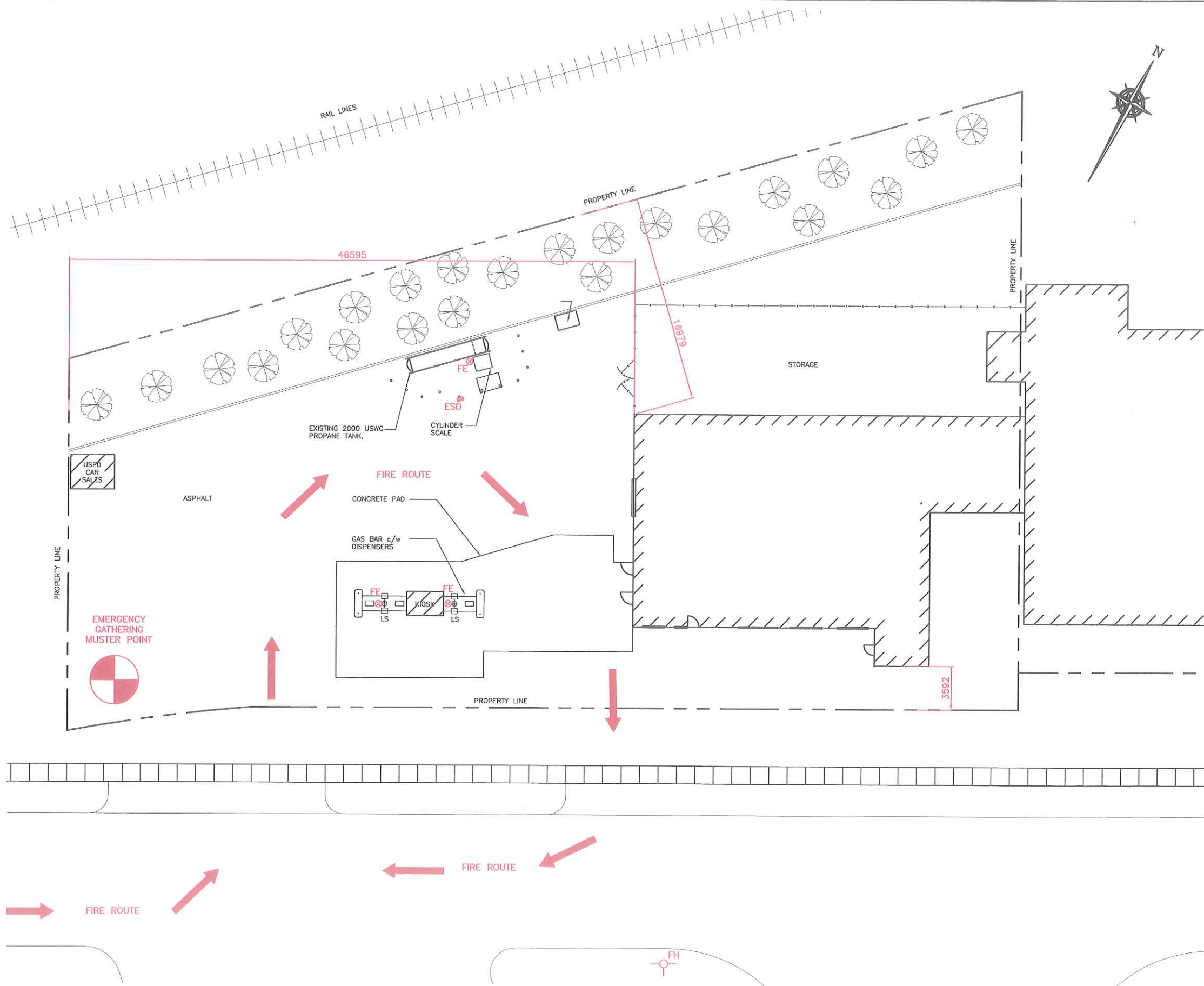

ZONING INFORMATION:

ZONING IS HIGHWAY COMMERCIAL (C2 ZONE).
 LOT AREA: 3128.1sq.m.
 BUILDING AREA: 503.6sq.m.
 LOT COVERAGE OF BUILDING: 16.1%

NOTES:

1. FACILITY USED FOR CYLINDER REFILLING AND AUTO REFUELING ONLY.

PROPERTY LINE SETBACKS	
NORTH	7.6m
SOUTH	27.5m
EAST	43.8m
WEST	27.8m

GPS COORDINATES	
LATITUDE	LONGITUDE
43°33'18.92"N	80°13'56.11"W

LEGEND:

- FE ⊙ FIRE EXTINGUISHER
- FH ⊕ FIRE HYDRANT
- ESD ■ EMERGENCY SHUT-DOWN
- ⊕ MUSTER POINT

No.	Date	Description	By
1	JUN. 30, '15	ISSUED FOR RSMP OWNERSHIP CHANGE	JRK
0	NOV. 09, '11	ISSUED FOR RSMP APPROVAL	JRK

REVISIONS

Gino's Gas Bar

ALTENG Inc.
 Alternative Energy Consulting
 126 Holm Crescent, Thornhill, Ontario L3T 5J3
 Telephone: (905)764-1644 Fax: (905)764-5986

Project: 9200141 CANADA Inc. (o/a Gino's Gas Bar) 352 Elizabeth Street Guelph, ON N1E 2X7	Drawn By: D.F. Checked By: J.R.K. Date: NOV. 09, '11 Drawing Scale: 1:200
Drawing Number: P-101	File Number: 11510D
SITE & EMERGENCY FIRE PLAN	
ACAD INFORMATION	
Drawing File: 115100-P-101	
Drawing Size: D	
Plotting Scale: 1=1	